



無錫東元電機
有限公司



2024.01.04

發圖章

TEB5(AFNY/AFNU)PN修订纪录
(32057R9919)

版号	日期	页次	内 容	依 据	備 註
00	2023/6/30	38	TEB5(AFNY/AFNU)PN	TEB5	
01	2023/12/26	52	TEB5(AFNY/AFNU)PN	TEB5	增加立式資料

第二原稿設變時
須由原單位處理

核定		審核					提案	劉慧枝
發行單位	上海東元	中壢設計課	台灣直營	金一品保課	金二品管課	品保中心	編號：32057R9919	
份數	X1	X1	X1	X1	X2	X2	版號：REV.01	

PRODUCT NOTE

CHANGE NOTICE

DWG .NO. 32057R9919

TECO'S MODEL : TEB5

Revision Date

VOL.

Revised or New Material

26-Dec-23

01

Revised Pages:

(Added vertical installation information)

TSH	1
RDC	1
WXDC	1
WXSM	1

APPD.	Seal	30-Jun-23	TECO Electric & Machinery Co., Ltd. Wuxi, China	DWG NO.	32057R9919	
CHKD.	WJ	30-Jun-23		REV. 01		1/2
DWN.	GGL	30-Jun-23				

ISSUED 30-Jun-23			SPECIFICATION TABLE FLAMEPROOF MOTORS Ex db LOW VOLTAGE SQUIRREL CAGE			MODEL TEB5			
REVISED 26-Dec-23						PAGE 1 of 52			
ITEM				STANDARD SPECIFICATION					
R A T I O N G	Kind of Motors			Squirrel - Cage Induction Motors (SCIM) .					
	Design Standards			GB , IEC.					
	Voltages			Fr#80-Fr#100: 220V,230V,380V,400V,415V,440V,460V,480V,200/346V,220/380V,230/400V, 240/415V,254/440V,265/460V,277/480V,220-240/380-415V,380-415V ; Fr#112-Fr#355: 220V,230V,380V,400V,415V,440V,460V,480V,525V,660V,690V,1140V, 200/346V,220/380V,230/400V,240/415V,254/440V,265/460V,277/480V, 380/660V,400/690V,660/1140V,220-240/380-415V,380-415V °					
	Frequency			50Hz .					
	Output Range			0.75 kW ~ 315 kW .					
				2 ~ 8 Poles.					
	Time Duty			Continuous. S1 , S.F. : 1.0 .					
	Frame Nos.			80M ~ 355L .					
	Protection Enclosure			Standard:Totally Enclosed Fan Cooled (IP55).					
				Option:IP65 (IIC)					
Cooling Method			Self External Fan , Surface Cooling (IC 411) .						
A P P L I C A T I O N	Environment Conditions			AFNY : Horizontal Foot Mounted B3 (IM 1001) . AFNU : Horizontal Flange Mounted B5 (IM 3001) . AFNY : Horizontal Foot And Flange Mounted B35 (IM 2001) . AFNU : Vertical Flange Mounting V1 (IM 3011) .					
				Place : Zone 1 Hazardous . Ambient Temperature : -20 ~40 °C . Relative Humidity : Less Than 90% RH (Non - Condensation) . Altitude : Less Than 1,000 Meters .					
				Hazardous Location					Suitable For Zone 1 , Ex db Group II A, II B , II C
				Power Source Conditions					Voltage : ±10% , Frequency : ±5% , and 10% Max. of Combined Voltage and Frequency . But Frequency Variation Does Not Exceed ±5% .
				Method of Starting					Full Voltage Direct On Line or Y - Starting .
Drive Method			Direct Coupling						
Direction of Rotation			CW According to GB Definition, Suitable For Bi - Directional Operation .						
APPD.			Sean	30-Jun-23	TECO Electric & Machinery Co., Ltd. Wuxi, China			DWG NO.	
CHKD.			JOB	30-Jun-23				32057R9920	
DWN.			GGL	30-Jun-23				REV. 01	
								1/3	

ISSUED 30-Jun-23			SPECIFICATION TABLE FLAMEPROOF MOTORS Ex db LOW VOLTAGE SQUIRREL CAGE			MODEL TEB5		
REVISED 26-Dec-23						PAGE 2 of 52		
ITEM				STANDARD SPECIFICATION				
C O N S T R U C T I O N	Dimensions			IM B3 DWG No. 32057R9922		IM B35 DWG No. 32057R9924		
				IM V1 DWG No. 32057R9925		IM B5 DWG No. 32057R9923		
	Frame			High Grade Cast Iron Has Enough Strength Against Required Explosion Pressure .				
	End Bracket			High Grade Cast Iron .				
	Fan Cover			SPCC .				
	External Fan			Conductive Polypropylene (Non - Sparking Material),Aluminum				
	Shaft			Carbon Steel , Cylindrical Single Extension with Keyway and Key .				
	Bearing			Bracket Mounting , Vacuum De - Gassed High Quality Open Bearings for Frame Nos. 160M ~ 355L , Grease Pre - Packed Shielded Rolling Bearings for the Others .				
	Lubrication			Mineral Oil , Li - Base Grease . Shell Alvania RL3 For Frame Nos .160M ~ 355L .				
	Lead Terminal			Max. 6 Leads , With Solderless Lug Terminals .				
	Shaft Seal			GAMMA Seal on Both End.				
	Terminal Box			Cast iron , Flameproof Construction , Over Size , The Cable are Let Out from Left or Right Direction When Facing The Drive End Side , Apart Only by Manufactory . There are two kinds of incoming wirings : rubber - sheathed cable , steel pipe wiring .				
	Iron Core			High Grade , Insulated , Cold - Rolled Electro - Magnetic Steel Plate .				
	Stator Winding			Pre - Formed , Random Wound , Made of Heavy , Polyester Enameled Copper Wire .				
	Stator Insulation			Class F Insulation System .				
	Varnish Treatment			Phenolic Alkyd Resin Varnish .				
	Rotor Winding			Squirrel Cage, Aluminium Conductor with End - Ring and Waffer Blades Integrally Cast .(Individuation : Copper Conductor with Welded End - Ring)				
	Painting			Phenolic Rust Proof Base Plus Lacquer Surface Finished Painting in Light - Gray Color (MUNSELL 7.5B 3.5/0.5) .				
	Name Plate			Stainless Steel Plate .				
	Bolt Thread			ISO Metric System (Strength Catagory 8.8T) .				
Grounding Terminal			One Terminal inside The Terminal Box. Another One On The Outside Of The Frame from more than 100kW.					
APPD.	Sean	30-Jun-23	TECO Electric & Machinery Co., Ltd. Wuxi, China			DWG NO.		
CHKD.	JOB	30-Jun-23				32057R9920		
DWN.	GGL	30-Jun-23				REV. 01		
						2/3		

ISSUED 30-Jun-23			SPECIFICATION TABLE FLAMEPROOF MOTORS Ex db LOW VOLTAGE SQUIRREL CAGE						MODEL TEB5	
REVISED 26-Dec-23									PAGE 3 of 52	
ITEM			STANDARD SPECIFICATION							
P E R F O R M A N C E	Test Procedure For Explosion Proof		According to GB/T 3836.1 , GB/T 3836.2 .							
	Test Procedure		GB/T 1032 Method B , IEC 60034-2-1 And Full Voltage Measuring Starting Performance .							
	Winding Temperature Rise		Not to Exceed 80K . By Resistance Method at S.F 1.0 Operation .							
	External Surface Temperature		Comply With Operating Temperature Code T4 For Sinusoidal Power . Comply With Operating Temperature Code T4 For inverter Power .							
	Over Speed		120% Syn. R.P.M. for 2 Min .							
	Over Torque		160% Rated Torque for 15 Sec .							
	Vibration (r.m.s)		Vibration grade	Shaft height / mm Mounting	63 ≤ H ≤ 132 Velocity mm/s	132 < H ≤ 280 Velocity mm/s	H > 280 Velocity mm/s			
A			Free suspension	1.6	2.2	2.8				
O T H E R	Certification Marking		Standard: Ex db II B T4 Gb (Fr#80~355)							
			Other Option:Ex db II C T4 Gb(Fr#80~355)							
	Certificate Number		Ex db II B T4 Gb (Fr#80~355)							
			F#	CJEx Number	F#	CJEx Number	F#	CJEx Number		
			80	Certifying	160	CJEx23.0429	280	CJEx23.0434		
			90	Certifying	180	CJEx23.0430	315	CJEx22.1594		
			100	Certifying	200	CJEx23.0431	355	CJEx22.1595		
			112	Certifying	225	CJEx23.0432				
			132	Certifying	250	CJEx23.0433				
			Ex db II C T4 Gb (Fr#80~355)							
			F#	CJEx Number	F#	CJEx Number	F#	CJEx Number		
			80	Certifying	160	CJEx23.0435	280	CJEx23.0440		
			90	Certifying	180	CJEx23.0436	315	CJEx22.1596		
			100	Certifying	200	CJEx23.0437	355	CJEx22.1597		
			112	Certifying	225	CJEx23.0438				
			132	Certifying	250	CJEx23.0439				
			Frame Nos. 80M ~ 132M : Orders are not Accepted while Certifying							
APPD.			Sean	30-Jun-23	TECO Electric & Machinery Co., Ltd. Wuxi, China					DWG NO. 32057R9920 REV. 01
CHKD.	JOB	30-Jun-23								
DWN.	GGL	30-Jun-23								
								3/3		

ISSUED 30-Jun-23				PERFORMANCE DATA IE5 EFFICIENCY 3-PHASE INDUCTION MOTORS LOW VOLTAGE SQUIRREL CAGE										MODEL TEB5				
REVISED 26-Dec-23														PAGE 4 of 52				
TEFC, CLASS F, 40℃ AMBIENT TEMP. IEC ; GB DESIGN N CONTINUOUS DUTY S.F. 1.0, 380V 50HZ																		
GB1/IE5																		
(2 POLE)				TYPICAL PERFORMANCE										(380V)				
OUTPUT		FULL LOAD	FRAME NO.	EFFICIENCY			POWER FACTOR			CURRENT		TORQUE				ROTOR GD ² kg-m ²	NOISE SOUND PRESSURE NO-LOAD dB(A)	APPROX. WEIGHT kg
kW	hp			FULL LOAD	3/4 LOAD	1/2 LOAD	FULL LOAD	3/4 LOAD	1/2 LOAD	FULL LOAD	LOCKED ROTOR	FULL LOAD	LOCKED ROTOR	PULL UP	BREAK DOWN			
		rpm		(%)	(%)	(%)	(%)	(%)	(%)	(A)	%FLC	kg-m	%FLT	%FLT	%FLT			
0.75	1	2905	80M	86.3	86.3	84.8	83.0	76.0	64.0	1.59	920	0.252	300	250	330	0.009	69	20.5
1.1	1.5	2900	80M	87.8	87.2	85.5	84.0	77.5	65.5	2.27	930	0.370	300	250	330	0.010	69	29.5
1.5	2	2890	90S	88.9	88.9	88.1	86.0	81.0	70.5	2.98	950	0.506	300	250	330	0.014	69	36.0
2.2	3	2895	90L	90.2	90.9	90.8	86.5	82.0	72.5	4.28	950	0.741	300	250	330	0.022	69	43.5
3	4	2905	100L	91.1	91.5	90.9	86.5	82.0	72.5	5.78	960	1.006	300	250	330	0.036	72	56.0
4	5.5	2910	112M	91.8	92.6	92.9	87.0	83.5	76.5	7.61	970	1.340	300	250	330	0.076	73	80.0
5.5	7.5	2935	132S	92.6	92.9	92.0	87.0	83.5	74.5	10.4	990	1.826	275	215	330	0.079	75	95.0
7.5	10	2945	132S	93.3	93.8	93.7	88.0	84.5	76.5	13.9	960	2.482	260	210	330	0.121	75	108.0
11	15	2955	160M	94.0	94.3	94.0	90.0	87.0	79.5	19.8	930	3.628	250	200	300	0.283	77	172
15	20	2960	160M	94.5	94.8	94.8	90.0	87.0	81.0	26.8	950	4.938	280	225	310	0.340	77	187
18.5	25	2955	160L	94.9	95.1	94.9	90.0	87.0	78.5	32.9	970	6.101	290	240	320	0.396	77	202
22	30	2970	180M	95.1	95.4	95.2	90.5	88.5	83.0	38.8	980	7.218	300	180	330	0.723	77	274
30	40	2975	200L	95.5	95.3	94.7	92.0	91.0	87.0	51.9	950	9.827	210	180	330	1.414	79	357
37	50	2980	200L	95.8	95.4	94.8	92.0	89.5	83.5	63.8	960	12.10	230	160	330	1.527	79	370
45	60	2975	225M	96.0	95.7	95.1	92.0	90.0	85.5	77.4	950	14.74	220	130	330	1.883	81	467
55	75	2975	250M	96.2	96.1	95.6	90.0	88.0	83.0	96.5	930	18.02	215	120	330	2.639	81	538
75	100	2975	280S	96.5	96.1	95.2	90.0	87.0	79.5	131	850	24.57	140	120	330	4.000	82	820
90	125	2975	280M	96.6	96.3	95.6	90.5	88.0	81.0	156	820	29.48	140	120	300	4.400	82	890
110	150	2980	315S	96.8	96.6	95.9	90.0	88.0	82.5	192	900	35.97	140	120	260	6.000	86	1300
132	175	2980	315M	96.9	96.8	96.2	91.0	89.5	85.0	227	900	43.17	140	120	260	7.200	86	1460
160	215	2980	315L	97.0	96.9	96.4	91.5	90.0	86.0	274	900	52.32	150	125	260	8.000	86	1600
200	270	2980	315L	97.2	97.1	96.6	91.5	90.0	86.0	342	950	65.40	160	130	260	9.600	86	1750
250	335	2980	355M	97.2	97.1	96.8	91.0	89.5	85.0	429	800	81.75	130	115	230	15.20	87	2000
315	420	2980	355L	97.2	97.1	96.8	91.0	89.5	85.0	541	850	103.0	150	130	250	18.80	87	2400
<div>NOTE : 1. The above are typical values based on test according to GB/T 1032 method B, IEC 60034-2-1:2014.</div> <div>2. Tolerance according to GB 755, IEC 60034-1.</div> <div>3. Breakdown & Locked rotor torques are show as average expected voltages.</div> <div>4. Efficiency, power factor, speed and torque are the same for other voltages.</div> <div>Current values vary inversely with voltage.</div> <div>5. Noise : sound pressure level at no - load, dB(A), Tolerance + 3 dB(A)</div> <div>6. Data subject to change without notice.</div>																		
APPD.		Sean		30-Jun-23		TECO Electric & Machinery Co., Ltd. Wuxi, China						DWG NO.						
CHKD.		JOB		30-Jun-23								32057R9921						
DWN.		GGL		30-Jun-23								REV. 01						
1/3																		

ISSUED 30-Jun-23	PERFORMANCE DATA IE5 EFFICIENCY 3-PHASE INDUCTION MOTORS LOW VOLTAGE SQUIRREL CAGE	MODEL TEB5
REVISED 26-Dec-23		PAGE 5 of 52

TEFC, CLASS F, 40°C AMBIENT TEMP.
 IEC ; GB DESIGN N CONTINUOUS DUTY
 S.F. 1.0, 380V 50HZ

GB1/IE5

(4 POLE)

TYPICAL PERFORMANCE

(380V)

OUTPUT		FULL LOAD	FRAME NO.	EFFICIENCY			POWER FACTOR			CURRENT		TORQUE				ROTOR GD ² kg-m ²	NOISE SOUND PRESSURE NO-LOAD dB(A)	APPROX. WEIGHT kg
				FULL LOAD	3/4 LOAD	1/2 LOAD	FULL LOAD	3/4 LOAD	1/2 LOAD	FULL LOAD	LOCKED ROTOR	FULL LOAD	LOCKED ROTOR	PULL UP	BREAK DOWN			
kW	hp	rpm		(%)	(%)	(%)	(%)	(%)	(%)	(A)	%FLC	kg-m	%FLT	%FLT	%FLT			
0.75	1	1440	80M	88.2	88.2	86.4	71.0	61.5	49.5	1.82	930	0.508	300	250	350	0.023	57	22.0
1.1	1.5	1455	90S	89.5	89.8	88.7	77.0	69.5	56.0	2.43	930	0.737	300	250	350	0.031	57	41.0
1.5	2	1455	90L	90.4	90.3	89.6	77.0	69.5	56.5	3.27	910	1.005	300	250	350	0.039	57	44.5
2.2	3	1470	100L	91.4	91.0	89.8	77.5	70.5	57.5	4.72	910	1.458	300	250	350	0.074	60	57.5
3	4	1470	100L	92.1	91.9	91.0	77.5	71.0	59.0	6.39	910	1.989	300	250	350	0.089	60	63.0
4	5.5	1470	112M	92.8	92.2	90.8	78.5	71.0	58.0	8.34	920	2.652	300	250	350	0.155	62	90.0
5.5	7.5	1470	132S	93.4	93.1	92.3	80.0	74.0	62.0	11.2	955	3.646	300	250	350	0.222	65	111
7.5	10	1475	132M	94.0	93.5	92.5	80.0	73.0	61.5	15.2	980	4.955	280	245	350	0.252	65	127
11	15	1480	160M	94.6	94.9	94.6	82.0	79.5	70.0	21.5	870	7.243	280	225	285	0.773	67	191
15	20	1485	160L	95.1	95.0	94.2	82.0	77.0	66.0	29.2	890	9.843	300	265	320	0.928	67	211
18.5	25	1480	180M	95.3	95.2	94.8	85.0	80.5	71.0	34.7	890	12.18	300	265	360	1.451	69	261
22	30	1480	180L	95.5	95.5	95.1	85.0	80.5	71.5	41.2	890	14.49	325	265	360	1.766	69	289
30	40	1485	200L	95.9	95.8	95.3	85.0	81.0	71.5	55.9	860	19.69	280	215	300	2.556	72	389
37	50	1485	225S	96.1	95.9	95.3	87.0	83.0	74.0	67.2	850	24.28	255	210	285	4.490	73	472
45	60	1485	225M	96.3	96.3	96.0	87.0	83.5	75.0	81.6	850	29.53	290	235	320	5.214	73	512
55	75	1485	250M	96.5	96.3	95.8	87.0	82.5	73.5	100	850	36.09	270	180	320	6.651	74	587
75	100	1488	280S	96.7	96.5	96.0	86.5	82.0	72.0	136	750	49.12	160	140	280	8.000	77	880
90	125	1488	280M	96.9	96.7	96.2	86.2	82.0	72.0	164	750	58.94	160	140	280	9.200	77	960
110	150	1490	315S	97.0	96.9	96.4	87.0	83.0	74.0	198	780	71.94	180	150	280	17.600	82	1460
132	175	1490	315M	97.1	97.0	96.6	87.5	83.8	74.8	236	780	86.33	180	150	280	19.600	82	1650
160	215	1488	315L	97.2	97.1	96.7	88.4	85.0	77.0	283	780	104.8	200	170	280	25.20	82	1820
200	270	1488	315L	97.4	97.3	97.0	87.8	84.0	75.0	355	800	131.0	200	170	280	27.20	82	1950
250	335	1490	355M	97.4	97.4	97.0	90.5	89.0	84.0	431	780	163.5	150	130	260	35.60	82	2400
315	420	1490	355L	97.4	97.4	97.0	90.5	89.0	83.0	543	780	206.0	160	140	280	42.80	82	2650

- NOTE : 1. The above are typical values based on test according to GB/T 1032 method B, IEC 60034-2-1:2014.
 2. Tolerance according to GB 755, IEC 60034-1.
 3. Breakdown & Locked rotor torques are show as average expected voltages.
 4. Efficiency, power factor, speed and torque are the same for other voltages.
 Current values vary inversely with voltage.
 5. Noise : sound power pressure level at no - load, dB(A), Tolerance + 3 dB(A)
 6. Data subject to change without notice.

APPD.	Sean	30-Jun-23	TECO Electric & Machinery Co., Ltd. Wuxi, China	DWG NO.
CHKD.	JOB	30-Jun-23		32057R9921
DWN.	GGL	30-Jun-23		REV. 01 2/3

ISSUED 30-Jun-23	PERFORMANCE DATA IE5 EFFICIENCY 3-PHASE INDUCTION MOTORS LOW VOLTAGE SQUIRREL CAGE	MODEL TEB5
REVISED 26-Dec-23		PAGE 6 of 52

TEFC, CLASS F, 40°C AMBIENT TEMP.
 IEC ; GB DESIGN N CONTINUOUS DUTY
 S.F. 1.0, 380V 50HZ

GB1/IE5

(6 POLE)

TYPICAL PERFORMANCE

(380V)

OUTPUT		FULL LOAD rpm	FRAME NO.	EFFICIENCY			POWER FACTOR			CURRENT		TORQUE				ROTOR GD ² kg-m ²	NOISE SOUND PRESSURE NO-LOAD dB(A)	APPROX. WEIGHT kg
kW	hp			FULL LOAD (%)	3/4 LOAD (%)	1/2 LOAD (%)	FULL LOAD (%)	3/4 LOAD (%)	1/2 LOAD (%)	FULL LOAD (A)	LOCKED ROTOR %FLC	FULL LOAD kg-m	LOCKED ROTOR %FLT	PULL UP %FLT	BREAK DOWN %FLT			
0.75	1	960	90S	85.7	85.4	83.2	63.0	53.5	40.5	2.11	820	0.761	260	230	320	0.031	53	40.0
1.1	1.5	960	90L	87.2	86.6	84.6	63.0	52.5	39.5	3.04	810	1.117	280	240	340	0.041	53	45.0
1.5	2	965	100L	88.4	88.4	87.3	68.0	59.5	46.5	3.79	800	1.515	245	165	300	0.070	53	55.5
2.2	3	985	112M	89.7	89.2	87.7	66.0	58.5	46.0	5.65	800	2.177	260	220	330	0.093	59	75.0
3	4	970	132S	90.6	90.7	89.8	72.0	63.5	50.0	6.99	830	3.014	200	185	305	0.166	62	96
4	5.5	970	132M	91.4	91.7	91.3	72.0	64.0	51.0	9.24	890	4.019	200	190	310	0.217	62	108
5.5	7.5	975	132M	92.2	92.2	91.4	73.0	64.5	50.5	12.4	890	5.497	280	245	360	0.280	62	122
7.5	10	975	160M	92.9	92.1	90.6	77.0	69.5	56.5	15.9	830	7.496	280	260	300	1.401	62	199
11	15	985	160L	93.7	93.5	92.8	77.5	70.5	57.5	23.0	830	10.88	280	270	300	1.592	62	213
15	20	985	180L	94.3	94.3	93.7	79.5	73.0	60.0	30.4	830	14.84	290	225	310	2.244	66	282
18.5	25	990	200L	94.6	94.7	93.8	81.0	75.0	63.0	36.7	830	18.21	300	235	310	3.256	69	362
22	30	990	200L	94.9	94.8	94.1	83.0	78.0	67.0	42.4	800	21.66	290	210	310	3.489	69	374
30	40	990	225M	95.3	95.3	94.9	83.5	78.5	68.0	57.3	800	29.53	270	225	305	5.288	69	458
37	50	985	250M	95.6	95.6	95.2	83.5	78.5	67.5	70.4	800	36.61	180	170	305	7.454	71	525
45	60	990	280S	95.8	95.6	94.9	83.2	78.0	67.5	85.8	800	44.29	180	150	300	11.20	74	860
55	75	990	280M	96.0	95.8	95.2	84.2	79.5	70.0	103	800	54.14	180	150	300	13.60	74	940
75	100	992	315S	96.3	96.2	95.8	85.0	81.0	72.0	139.2	750	73.68	140	120	260	24.40	77	1460
90	125	992	315M	96.5	96.3	96.0	85.0	81.5	72.5	167	750	88.41	140	120	260	28.80	77	1200
110	150	990	315L	96.6	96.5	96.0	85.0	80.0	71.0	204	780	108.3	160	145	260	33.20	77	1650
132	175	990	315L	96.8	96.7	96.2	85.5	81.5	72.5	242	800	129.9	170	150	260	41.60	77	1730
160	215	992	355M	96.9	96.8	96.3	85.0	81.0	71.5	295	770	157.2	140	120	250	40.40	81	1950
200	270	992	355M	97.0	97.0	96.5	85.0	81.5	72.5	369	770	196.5	140	120	250	47.60	81	2150
250	335	992	355L	97.0	97.0	96.7	86.0	83.0	75.0	455	740	245.6	140	120	250	54.80	81	2400

- NOTE :
- The above are typical values based on test according to GB/T 1032 method B, IEC 60034-2-1:2014.
 - Tolerance according to GB 755, IEC 60034-1.
 - Breakdown & Locked rotor torques are show as average expected voltages.
 - Efficiency, power factor, speed and torque are the same for other voltages.
Current values vary inversely with voltage.
 - Noise : sound power pressure level at no - load, dB(A), Tolerance + 3 dB(A)
 - Data subject to change without notice.

APPD.	Sean	30-Jun-23	TECO Electric & Machinery Co., Ltd. Wuxi, China	DWG NO.
CHKD.	JOB	30-Jun-23		32057R9921
DWN.	GGL	30-Jun-23		REV. 01 3/3

ISSUED 30-Jun-23	OUTLINE DIMENSIONS SHEET FLAMEPROOF MOTORS Ex d B3 (IM 1001) FRAME NOS. 80M ~ 100L	MODEL TEB5
REVISED 26-Dec-23		PAGE 7 of 52

Totally Enclosed Fan - Cooled Type, Squirrel - Cage Rotor.

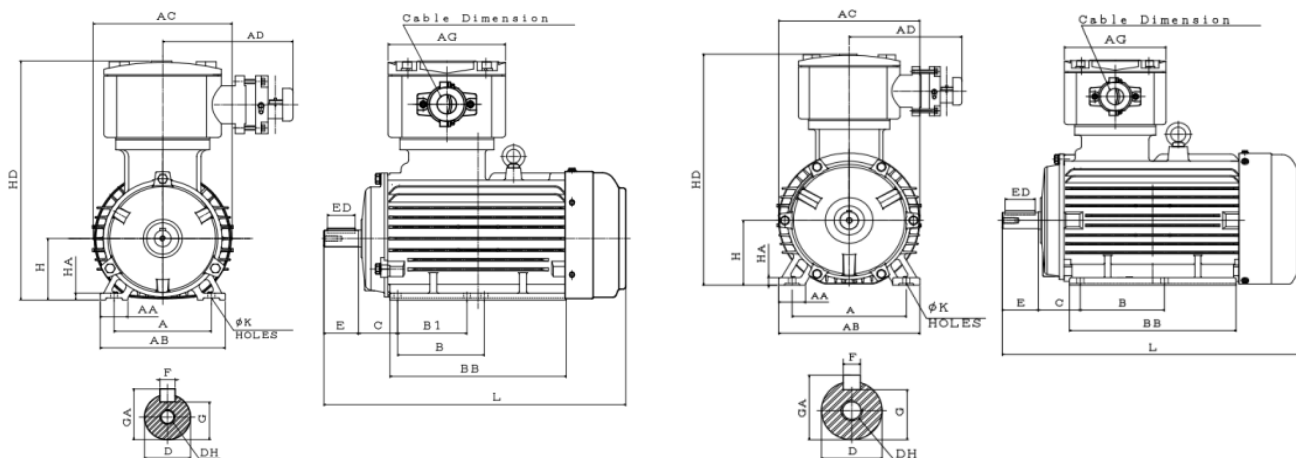

FIG.1

FIG.2

Dimensions in mm

Output (kW)				FRAME	A	AA	AB	AC	AD	AG	B1	B	BB	C	H	HA	HD	K	L
2P	4P	6P	8P	SIZE															
0.75	-	-	0.18	80M	125	34.5	161	175	187.5	169	無	100	222	50	80	10	326	10	380
1.1	0.75	-	0.25																
1.5	1.1	0.75	0.37	90L	140	40	180	202			100	125	284	56	90		350		465
2.2	1.5	1.1	0.55																
3	2.2	1.5	0.75	100L	160		200	216			無	140	295	63	100	12	375	12	503
	3	1.1																	
4	4	2.2	1.5	112M	190	45	235	240					342	70	112	13	400	12	566

		SHAFT EXTENSION							BEARING		EXPORT WIRE	THE RANGE of
FRAME SIZE	FIG. NO.	D	E	ED	F	G	GA	DH	DRIVE END	OPPOSITE	SIZE of CABLE	outer DIAMETER
										DRIVE END	GLAND BODY	of INLET CABLE
80M	1	19	40	32	6	15.5	21.5	M6X16	6204ZZC3	6204ZZC3	rubber sheath cable or M30x2 or NPT 1"	Ø 13~Ø 22
90L		24	50	40	8	20	27	M8X19	6205ZZC3	6205ZZC3		
100L		28	60	50		24	31	M10X22	6206ZZC3	6206ZZC3		
112M	2											

Note : 1. Tolerance of Shaft End Diameter D : j6 .
2. Tolerance of shaft center height H : +0,-0.5.

APPD.	Sean	30-Jun-23	TECO Electric & Machinery Co., Ltd. Wuxi, China	DWG NO.
CHKD.	JOB	30-Jun-23		32057R9922
DWN.	GGL	30-Jun-23		REV. 01 1/5

ISSUED 30-Jun-23	OUTLINE DIMENSIONS SHEET FLAMEPROOF MOTORS Ex db B3 (IM 1001) FRAME NOS. 180M ~225M	MODEL TEB5
REVISED 26-Dec-23		PAGE 9 of 52

Totally Enclosed Fan - Cooled Type, Squirrel - Cage Rotor.

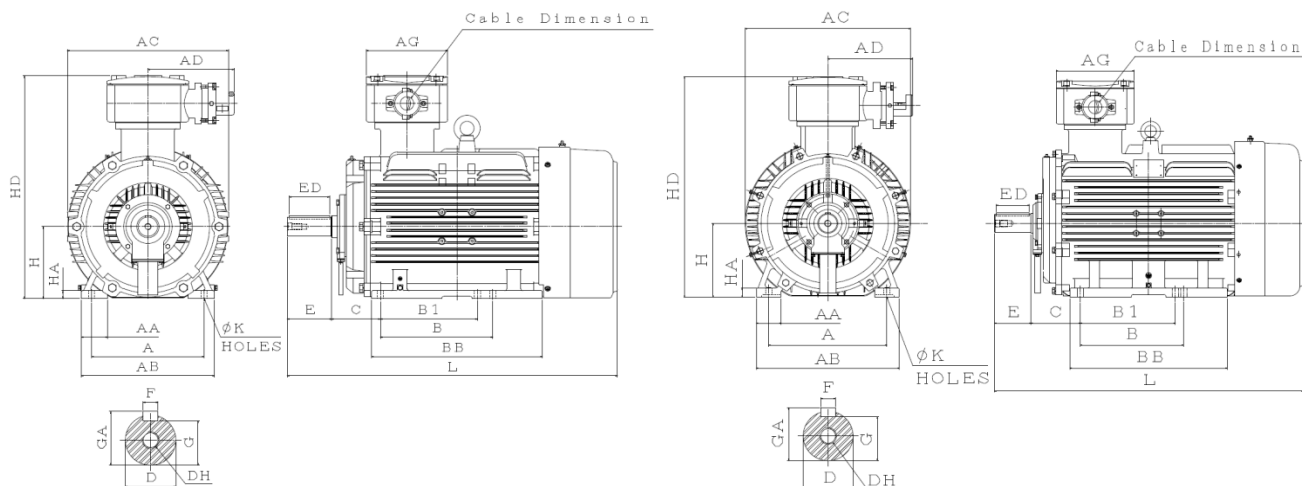

FIG.5

FIG.6

Dimensions in mm

Output (kW)				FRAME	A	AA	AB	AC	AD	AG	B1	B	BB	C	H	HA	HD	K	L
2P	4P	6P	8P	SIZE															
22	18.5	—	—	180M	279	65	330	400	209	202	無	241	424	121	180	20	557	14.5	819
—	22	15	11	180L							241	279							
30	30	18.5	15	200L	318	70	378	448	256	235	無	305	480	133	200	24	622	18.5	923
37		22										311							
—	37	—	18.5	225M	356	75	431	498			286	311	475	149	225	28	672		(931) 961
45	45	30	22																

SHAFT EXTENSION					BEARING					EXPORT WIRE		THE RANGE of outer DIAMETER of INLET CABLE
FRAME SIZE	FIG. NO.	D	E	ED	F	G	GA	DH	DRIVE END	OPPOSITE DRIVE END	SIZE of CABLE GLAND BODY	
180M	5	48	110	100	14	42.5	51.5	M16X36	6311C3	6310C3	rubber sheath cable or M36x2 or NPT 1.25"	Ø 13~Ø 28
180L												
200L												
225M	6	(55) 60	(110) 140	(100) 125	(16) 18	(49) 53	(59) 64	M20X42	(6312C3) 6313C3	(6212C3) 6213C3	rubber sheath cable or M48x2 or NPT 1.5" or NPT 2"	Ø 19~Ø 37

Note : 1. Tolerance of shaft end diameter D : 1) F#180 : k6. 2) F#200L~225M : m6.
2. Tolerance of shaft center height H : +0,-0.5.
3. No. in () is for 2P.

APPD.	Sean	30-Jun-23	TECO Electric & Machinery Co., Ltd. Wuxi, China	DWG NO.
CHKD.	JOB	30-Jun-23		32057R9922
DWN.	GGL	30-Jun-23		REV. 01 3/5

ISSUED 30-Jun-23	OUTLINE DIMENSIONS SHEET FLAMEPROOF MOTORS Ex db B3 (IM 1001) FRAME NOS. 250M ~ 315M	MODEL TEB5
REVISED 26-Dec-23		PAGE 10 of 52

Totally Enclosed Fan - Cooled Type, Squirrel - Cage Rotor.

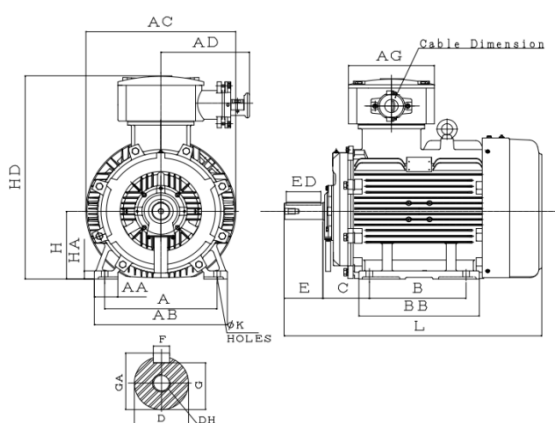

FIG.7

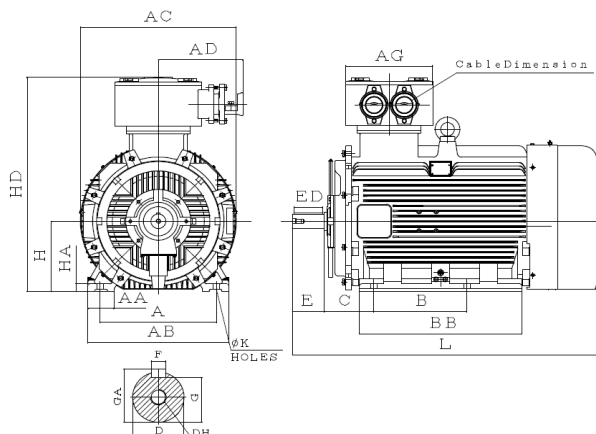

FIG.8

Dimensions in mm

Output (kW)				FRAME SIZE	A	AA	AB	AC	AD	AG	B	BB	C	H	HA	HD	K	L
2P	4P	6P	8P															
55	55	37	30		250M	406	85	480	542			349	509	168	250	30	750	1005
75	75	45	37		280S	457	85	535	630	320	310	368	546	190	280	35	810	24
90	90	55	45		280M							419	586					
110	110	75	55		315S	508	115	615	686	370	380	406	710	216	315	35	958	28
132	132	90	75		315M							457	810					

FRAME SIZE	FIG. NO.	SHAFT EXTENSION							BEARING		EXPORT WIRE	THE RANGE of outer DIAMETER of INLET CABLE
		D	E	ED	F	G	GA	DH	DRIVE END	OPPOSITE DRIVE END	SIZE of CABLE GLAND BODY	
250M	7	(60) 65	140	125	18	(53) 58	(64) 69	M20X42	(6313C3) 6315C3	(6313C3) 6313C3	rubber sheath cable or M64X2 or NPT 2.5"	Ø 24~Ø 40
280S		(65) 75			(18) 20	(58) 67.5	(69) 79.5		(6314C3) 6318C3	(6314C3) 6316C3		
280M												
315S	8	(65) 80	(140) 170	(125) 160	(18) 22	(58) 71	(69) 85	M20X40	(6316C3) 6320C3	(6314C3) 6316C3	rubber sheath cable or M64x2 or M63X1.5 or NPT 2.5"	Ø 38~Ø 58
315M												

- Note :**
1. Tolerance of Shaft End Diameter D : m6 .
 2. Tolerance of shaft center height H : 1)For #250, +0,-0.5; 2)For #280,315, +0,-1.
 3. No. in () is for 2P.

APPD.	Sean	30-Jun-23	TECO Electric & Machinery Co., Ltd. Wuxi, China	DWG NO.
CHKD.	JOB	30-Jun-23		32057R9922
DWN.	GGL	30-Jun-23		REV. 01 4/5

ISSUED 30-Jun-23	OUTLINE DIMENSIONS SHEET FLAMEPROOF MOTORS Ex db B3 (IM 1001) FRAME NOS. 315L ~ 355L	MODEL TEB5
REVISED 26-Dec-23		PAGE 11 of 52

Totally Enclosed Fan - Cooled Type, Squirrel - Cage Rotor.

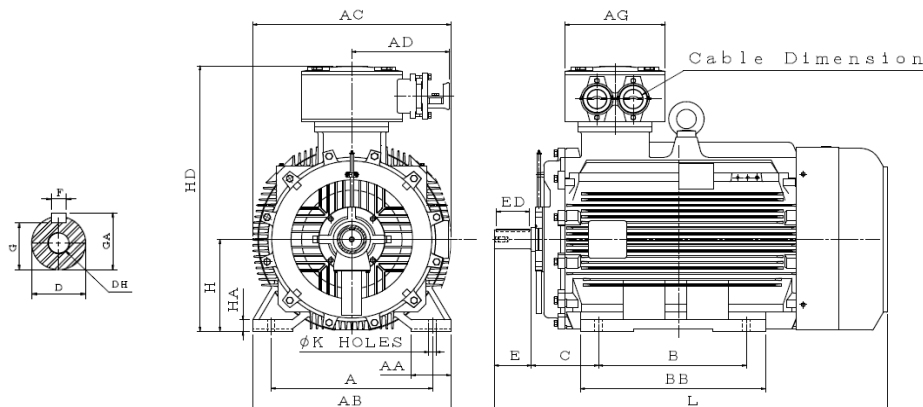

FIG.9

Dimensions in mm

Output (kW)				FRAME SIZE	A	AA	AB	AC	AD	AG	B	BB	C	H	HA	HD	K	L
2P	4P	6P	8P															
160	160	110	90	315L	508	115	615	686	370	380	508	810	216	315	35	958	28	(1454) 1484
185	185	132	110															
200	200	—	—															
220	220	160	132															(1570) 1600
250	250	200	160	355M	610	150	750	750			560	700	254	355	45	1025		(1620) 1650
280	280	220	185															
315	315	250	200	355L							630	770						

		SHAFT EXTENSION							BEARING		EXPORT WIRE	THE RANGE of	
FRAME	FIG.	D	E	ED	F	G	GA	DH	DRIVE END	OPPOSITE	SIZE of CABLE	outer DIAMETER	
SIZE	NO.									DRIVE END	GLAND BODY		
315L	8	(65) 80	(140) 170	(125) 160	(18) 22	(58) 71	(69) 85	M20X40	(6316C3) 6320C3	(6314C3) 6316C3	rubber sheath cable or M64x2 or M63x1.5 or NPT 2.5"	Ø38~Ø58	
355M	9	(75) 95			(20) 25	(67.5) 86	(79.5) 100	(M20X40) M24X48	(6317C3) 6322C3	(6317C3) 6322C3			
355L													

- Note :**
1. Tolerance of Shaft End Diameter D : m6 .
 2. Tolerance of shaft center height H : +0,-1.
 3. No. in () is for 2P.

APPD.	Sean	30-Jun-23	TECO Electric & Machinery Co., Ltd. Wuxi, China	DWG NO. 32057R9922 REV. 01
CHKD.	JOB	30-Jun-23		
DWN.	GGL	30-Jun-23		

ISSUED 26-Dec-23	OUTLINE DIMENSIONS SHEET FLAMEPROOF MOTORS Ex db B5 (IM 3001) FRAME NOS. 80M~100L	MODEL TEB5
REVISED		PAGE 12 of 52

Totally Enclosed Fan - Cooled Type, Squirrel - Cage Rotor.

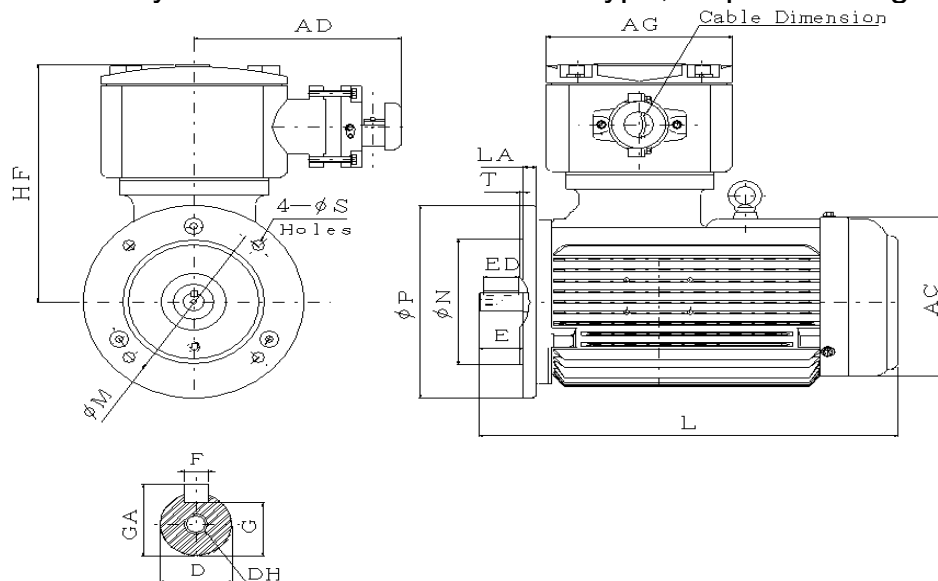

FIG.1

Dimensions in mm

Output (kW)				FRAME SIZE	FLANGE DIMENSION						AC	HF	AD	AG	L
2P	4P	6P	8P		LA	M	N	P	S	T					
0.75	-	-	0.18	80M	12	165	130	200	12	3.5	175	246	187.5	169	380
1.1	0.75	-	0.25								202	260			465
1.5	1.1	0.75	0.37	90L							216	275			503
2.2	1.5	1.1	0.55	100L	16	215	180	250	14.5	4	216	275			
3	2.2	1.5	0.75												
3	3	1.1	1.1												

FRAME SIZE	FIG. NO.	SHAFT EXTENSION							BEARING		EXPORT WIRE SIZE of CABLE GLAND BODY	THE RANGE of outer DIAMETER of INLET CABLE
		D	E	ED	F	G	GA	DH	DRIVE END	OPPOSITE DRIVE END		
80M	1	19	40	32	6	15.5	21.5	M6X16	6204ZZC3	6204ZZC3	rubber sheath cable or M30x2 or NPT 1"	Ø13~Ø22
90L		24	50	40	8	20	27	M8X19	6205ZZC3	6205ZZC3		
100L		28	60	50		24	31	M10X22	6206ZZC3	6206ZZC3		

- Note :**
1. Tolerance of Shaft End Diameter D : j6 .
 2. Tolerance of N : j6 .

APPD.	Sean	26-Dec-23	TECO Electric & Machinery Co., Ltd. Wuxi, China	DWG NO. 32057R9923 REV. 01
CHKD.	JOB	26-Dec-23		
DWN.	LHZ	26-Dec-23		

ISSUED	OUTLINE DIMENSIONS SHEET	MODEL
26-Dec-23		TEB5
REVISED	FLAMEPROOF MOTORS Ex db	PAGE
	B5 (IM 3001) FRAME NOS. 112M~160L	13 of 52

Totally Enclosed Fan - Cooled Type, Squirrel - Cage Rotor.

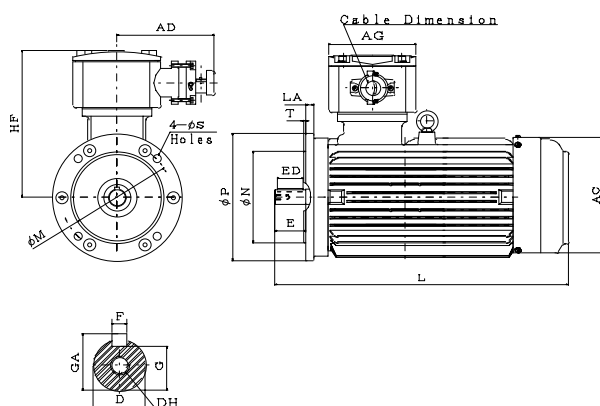

FIG.2

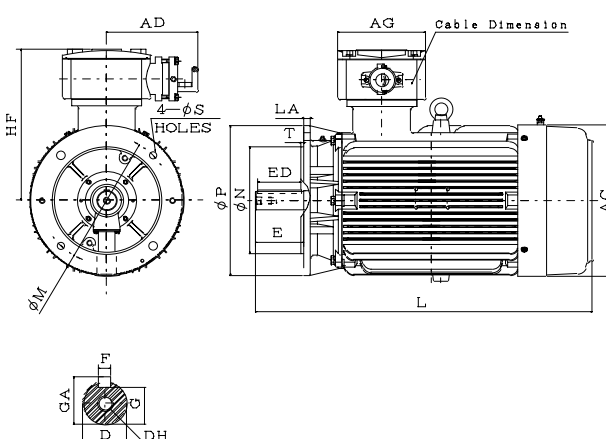

FIG.3

Dimensions in mm

Output (kW)				FRAME SIZE	FLANGE DIMENSION						AC	HF	AD	AG	L
2P	4P	6P	8P		LA	M	N	P	S	T					
4	4	2.2	1.5	112M	15	215	180	250			240	288			566
5.5	5.5	3	2.2	132S	16	265	230	300	14.5	4	273	295	187.5	169	570
7.5															
—	7.5	4	3	132M											606
		5.5													
11	11	7.5	4	160M											773
15		5.5													
18.5	15	11	7.5	160L		300	250	350	18.5	5	355	352	209	202	

FRAME SIZE	FIG. NO.	SHAFT EXTENSION							BEARING		EXPORT WIRE SIZE of CABLE GLAND BODY	THE RANGE of outer DIAMETER of INLET CABLE
		D	E	ED	F	G	GA	DH	DRIVE END	OPPOSITE DRIVE END		
112M	2	28	60	50	8	24	31	M10X22	6306ZZC3	6306ZZC3	rubber sheath cable or M30x2 or NPT1"	Ø13~Ø22
132S		38	80	70	10	33	41	M12X28	6308ZZC3	6306ZZC3		
132M												
160M	3	42	110	100	12	37	45	M16X36	6309C3	6307C3	rubber sheath cable or M36x2 or NPT 1.25"	Ø13~Ø28
160L												

Note : 1. Tolerance of Shaft End Diameter D : 1) F#112 M : j6. 2) F#132S~160L : k6.
2. Tolerance of N : j6 .

APPD.	Sean	26-Dec-23	TECO Electric & Machinery Co., Ltd. Wuxi, China	DWG NO.
CHKD.	JOB	26-Dec-23		32057R9923
DWN.	LHZ	26-Dec-23		REV. 01

ISSUED	OUTLINE DIMENSIONS SHEET	MODEL
26-Dec-23		TEB5
REVISED	FLAMEPROOF MOTORS Ex db	PAGE
	B5 (IM 3001) FRAME NOS. 180M~225M	14 of 52

Totally Enclosed Fan - Cooled Type, Squirrel - Cage Rotor.

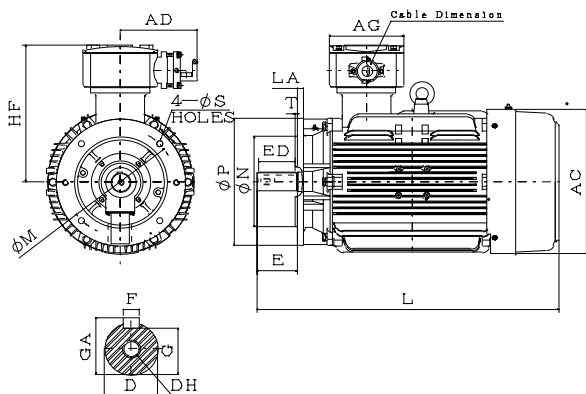

FIG.4

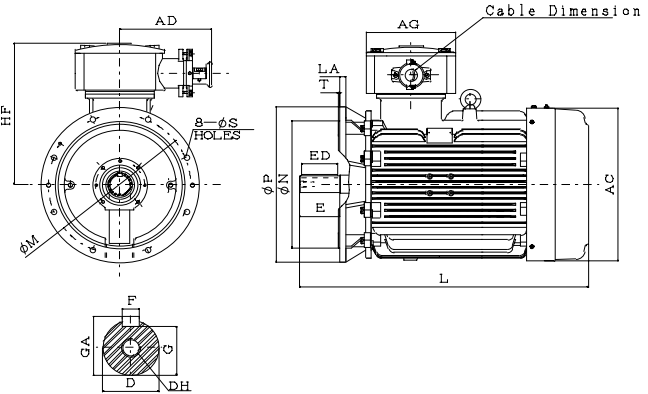

FIG.5

Dimensions in mm

Output (kW)				FRAME SIZE	FLANGE DIMENSION						AC	HF	AD	AG	L
2P	4P	6P	8P		LA	M	N	P	S	T					
22	18.5	—	—	180M	16	300	250	350	18.5	5	400	377	209	202	819
—	22	15	11	180L											
30	30	18.5	15	200L	17	350	300	400	18.5	5	448	422	256	235	923
37		22													
—	37	—	18.5	225M	20	400	350	450	18.5	5	498	447	256	235	(931) 961
45	45	30	22												

FRAME SIZE	FIG. NO.	SHAFT EXTENSION							BEARING		EXPORT WIRE SIZE of CABLE GLAND BODY	THE RANGE of outer DIAMETER of INLET CABLE
		D	E	ED	F	G	GA	DH	DRIVE END	OPPOSITE DRIVE END		
180M	4	48	110	100	14	42.5	51.5	M16X36	6311C3	6310C3	rubber sheath cable or M36x2 or NPT 1.25"	Ø13~Ø28
180L												
200L	5	55	110	100	16	49	59	M20X42	6312C3	6212C3	rubber sheath cable or M48x2 or NPT 1.5" or NPT 2"	Ø19~ Ø37
225M		(55) 60	(110) 140	(100) 125	(16) 18	(49) 53	(59) 64	M20X42	(6312C3) 6313C3	(6212C3) 6213C3		

- Note :**
1. Tolerance of Shaft End Diameter D : 1) F#180 : k6. 2) F#200L~225M : m6.
 2. Tolerance of N : j6 .
 3. No. in () is for 2P.
 4. Fr#225 : When installing the flange,the mounting bolt must be threaded in from the customer side.

APPD.	Sean	26-Dec-23	TECO Electric & Machinery Co., Ltd. Wuxi, China	DWG NO.
CHKD.	JOB	26-Dec-23		32057R9923
DWN.	LHZ	26-Dec-23		REV. 01
				3/4

ISSUED 30-Jun-23	OUTLINE DIMENSIONS SHEET FLAMEPROOF MOTORS Ex db B5 (IM 3001) FRAME NOS. 250M~280M	MODEL TEB5
REVISED 26-Dec-23		PAGE 15 of 52

Totally Enclosed Fan - Cooled Type, Squirrel - Cage Rotor.

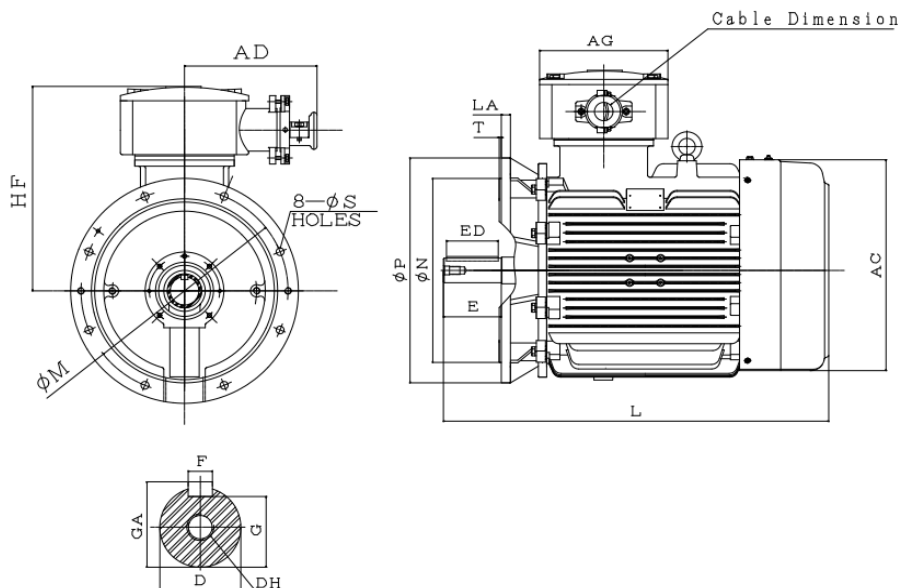

FIG.6

Dimensions in mm

Output (kW)				FRAME SIZE	FLANGE DIMENSION						AC	HF	AD	AG	L
2P	4P	6P	8P		LA	M	N	P	S	T					
55	55	37	30	250M							542	500			1005
75	75	45	37	280S	22	500	450	550	18.5	5	630	530	320	310	1161
90	90	55	45	280M											1201

FRAME SIZE	FIG. NO.	SHAFT EXTENSION							BEARING		EXPORT WIRE	THE RANGE of outer DIAMETER of INLET CABLE
		D	E	ED	F	G	GA	DH	DRIVE END	OPPOSITE DRIVE END	SIZE of CABLE GLAND BODY	
250M	6	(60) 65	140	125	18	(53) 58	(64) 69	M20X42	(6313C3) 6315C3	(6313C3) 6313C3	rubber sheath cable or M64X2 or NPT 2.5"	Ø 24~Ø 40
280S		(65) 75			(18) 20	(58) 67.5	(69) 79.5	M20X40	(6314C3) 6318C3	(6314C3) 6316C3		
280M												

- Note :**
1. Tolerance of Shaft End Diameter D : m6 .
 2. Tolerance of N : j6 .
 3. No. in () is for 2P.

APPD.	Sean	30-Jun-23	TECO Electric & Machinery Co., Ltd. Wuxi, China	DWG NO.
CHKD.	JOB	30-Jun-23		32057R9923
DWN.	GGL	30-Jun-23		REV. 01

ISSUED 30-Jun-23	OUTLINE DIMENSIONS SHEET FLAMEPROOF MOTORS Ex db B35 (IM 2001) FRAME NOS. 80M ~ 100L	MODEL TEB5
REVISED 26-Dec-23		PAGE 16 of 52

Totally Enclosed Fan - Cooled Type, Squirrel - Cage Rotor.

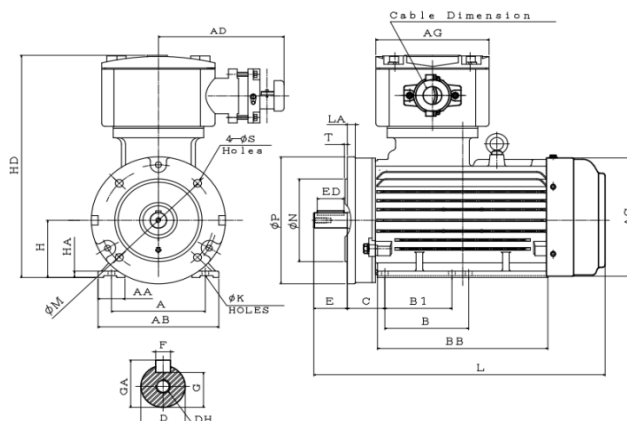

FIG.1

Dimensions in mm

Output (kW)				FRAME	FLANGE DIMENSION						A	AA	AB	AC	AD	AG	B1	B	BB	C	H
2P	4P	6P	8P	SIZE	LA	M	N	P	S	T											
0.75	-	-	0.18	80M	12	165	130	200	12	3.5	125	34.5	161	175	187.5	169	無	100	222	50	80
1.1	0.75	-	0.25																		
1.5	1.1	0.75	0.37	90L	12	165	130	200	12	3.5	140	40	180	202	187.5	169	100	125	284	56	90
2.2	1.5	1.1	0.55																		
3	2.2	1.5	0.75	100L	16	215	180	250	14.5	4	160	40	200	216	187.5	169	無	140	295	63	100
	3		1.1																		

FRAME SIZE	FIG. NO.	HA	HD	K	L	SHAFT EXTENSION						BEARING		EXPORT WIRE	THE RANGE of outer DIAMETER of INLET CABLE	
						D	E	ED	F	G	GA	DH	DRIVE END	OPPOSITE DRIVE END		SIZE of CABLE GLAND BODY
80M	1	10	326	10	380	19	40	32	6	15.5	21.5	M6X16	6204ZZC3	6204ZZC3	rubber sheath cable or M30x2 or NPT 1"	Ø13~Ø22
90L			350		465	24	50	40	8	20	27	M8X19	6205ZZC3	6205ZZC3		
100L		12	375	12	503	28	60	50		24	31	M10X22	6206ZZC3	6206ZZC3		

- Note :**
1. Tolerance of Shaft End Diameter D : j6 .
 2. Tolerance of shaft center height H : +0,-0.5.
 3. Tolerance of N : j6 .

APPD.	Sean	30-Jun-23	TECO Electric & Machinery Co., Ltd. Wuxi, China	DWG NO. 32057R9924 REV. 01 1/5
CHKD.	JOB	30-Jun-23		
DWN.	GGL	30-Jun-23		

ISSUED	OUTLINE DIMENSIONS SHEET	MODEL
30-Jun-23		TEB5
REVISED	FLAMEPROOF MOTORS Ex db	PAGE
26-Dec-23	B35 (IM 2001) FRAME NOS. 112M ~160L	17 of 52

Totally Enclosed Fan - Cooled Type, Squirrel - Cage Rotor.

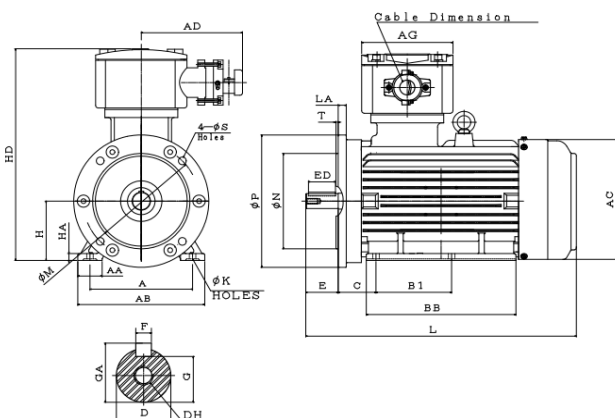

FIG.2

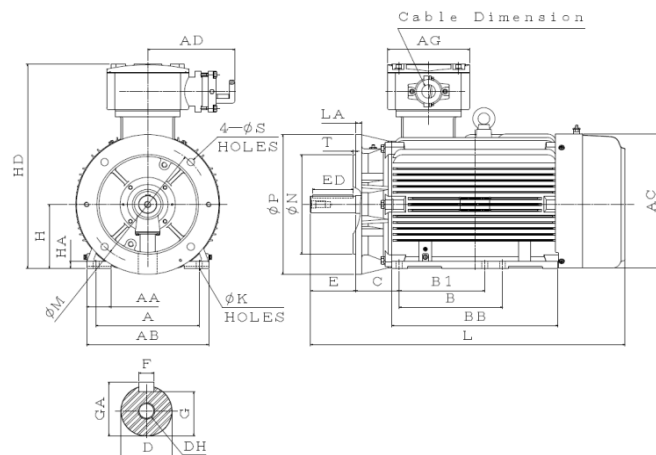

FIG.3

Dimensions in mm

Output (kW)				FRAME	FLANGE DIMENSION						A	AA	AB	AC	AD	AG	B1	B	BB	C	H										
2P	4P	6P	8P	SIZE	LA	M	N	P	S	T																					
4	4	2.2	1.5	112M	15	215	180	250	14.5	4	190	45	235	240	187.5	169	無	140	342	70	112										
5.5	5.5	3	2.2	132S	16	265	230	300			216	57	263	273					140	178	290	89	132								
7.5											—	7.5	4	3			132M	5.5													
11	11	7.5	4	160M							300	250	350	18.5			5	254	60	300	355	209	202	無	210	408	108	160			
15			5.5																												
18.5	15	11	7.5	160L																											210

FRAME SIZE	FIG. NO.	HA	HD	K	L	SHAFT EXTENSION							BEARING		EXPORT WIRE	THE RANGE of
						D	E	ED	F	G	GA	DH	DRIVE END	OPPOSITE DRIVE END	SIZE of CABLE	outer DIAMETER
112M	2	13	400	12	566	28	60	50	8	24	31	M10X22	6306ZZC3	6306ZZC3	rubber sheath cable or M30x2 or NPT1"	Ø13-Ø22
132S		16	427		570	38	80	70	10	33	41	M12X28	6308ZZC3	6306ZZC3		
132M					606											
160M	3	18	512	14.5	773	42	110	100	12	37	45	M16X36	6309C3	6307C3	rubber sheath cable or M36x2 or NPT 1.25"	Ø13-Ø28
160L																

Note : 1. Tolerance of Shaft End Diameter D : 1) F#112 M : j6. 2) F#132S~160L : k6.
2. Tolerance of N : j6 . 3. Tolerance of shaft center height H : +0,-0.5.

APPD.	Sean	30-Jun-23	TECO Electric & Machinery Co., Ltd.	DWG NO. 32057R9924
CHKD.	JOB	30-Jun-23		
DWN.	GGL	30-Jun-23		
			Wuxi, China	REV. 01 2/5

ISSUED	OUTLINE DIMENSIONS SHEET	MODEL
30-Jun-23		TEB5
REVISED	FLAMEPROOF MOTORS Ex db	PAGE
26-Dec-23	B35 (IM 2001) FRAME NOS. 180M ~225M	18 of 52

Totally Enclosed Fan - Cooled Type, Squirrel - Cage Rotor.

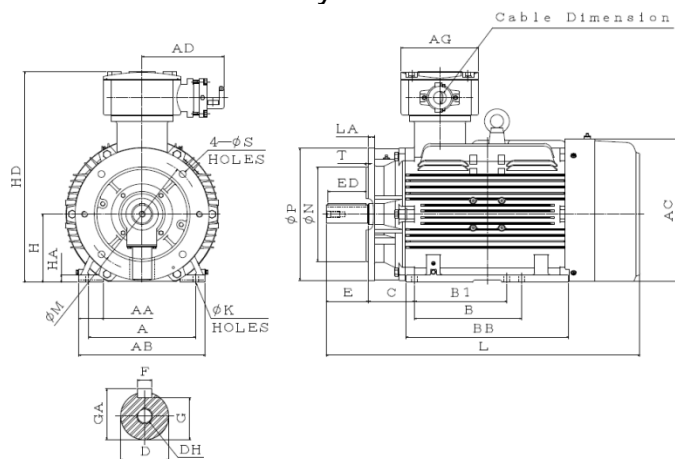

FIG.4

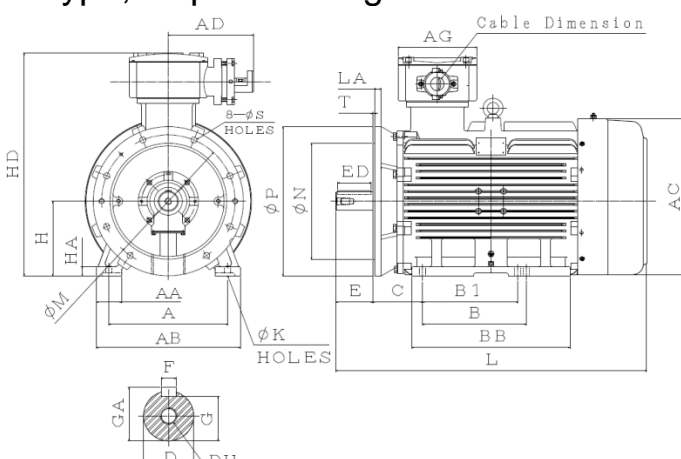

FIG.5

Dimensions in mm

Output (kW)				FRAME SIZE	FLANGE DIMENSION						A	AA	AB	AC	AD	AG	B1	B	BB	C	H
2P	4P	6P	8P		LA	M	N	P	S	T											
22	18.5	—	—	180M	16	300	250	350			279	65	330	400	209	202	無	241	424	121	180
—	22	15	11	180L													241	279			
30	30	18.5	15	200L	17	350	300	400	18.5	5	318	70	378	448			無	305	480	133	200
37		22													256	235					
—	37	—	18.5	225M	20	400	350	450			356	75	431	498			286	311	475	149	225
45	45	30	22																		

FRAME SIZE	FIG. NO.	HA	HD	K	L	SHAFT EXTENSION							BEARING		EXPORT WIRE	THE RANGE of
						D	E	ED	F	G	GA	DH	DRIVE END	OPPOSITE DRIVE END	SIZE of CABLE GLAND BODY	outer DIAMETER of INLET CABLE
180M	4	20	557	14.5	819	48	110	100	14	42.5	51.5	M16X36	6311C3	6310C3	rubber sheath cable or M36x2 or NPT 1.25"	Ø13~Ø28
180L																
200L		24	622	18.5	923	55			16	49	59	M20X42	6312C3	6212C3		
225M	5	28	672		(931) 961	(55) 60	(110) 140	(100) 125	(16) 18	(49) 53	(59) 64	M20X42	(6312C3) 6313C3	(6212C3) 6213C3		

- Note :**
1. Tolerance of Shaft End Diameter D : 1) F#180 : k6. 2) F#200L~225M : m6.
 2. Tolerance of N : j6 .
 3. No. in () is for 2P.
 4. Fr#225 : When installing the flange,the mounting bolt must be threaded in from the customer side.

APPD.	Sean	30-Jun-23	TECO Electric & Machinery Co., Ltd.	DWG NO. 32057R9924
CHKD.	JOB	30-Jun-23		
DWN.	GGL	30-Jun-23		
			Wuxi, China	REV. 01 3/5

ISSUED	OUTLINE DIMENSIONS SHEET				MODEL
30-Jun-23					TEB5
REVISED	FLAMEPROOF MOTORS Ex db				PAGE
26-Dec-23					19 of 52

B35 (IM 2001) FRAME NOS. 250M ~ 315M

Totally Enclosed Fan - Cooled Type, Squirrel - Cage Rotor.

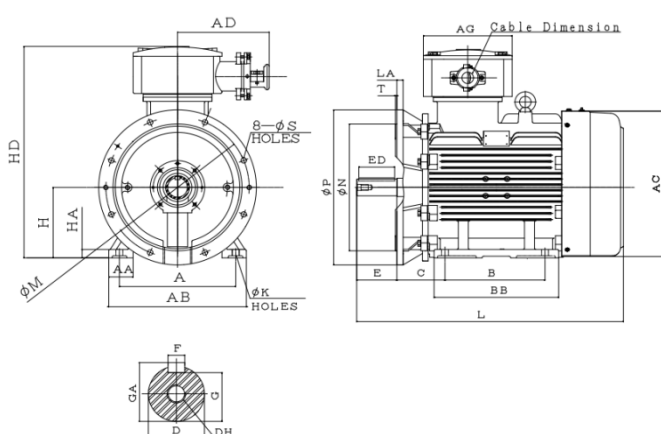

FIG.6

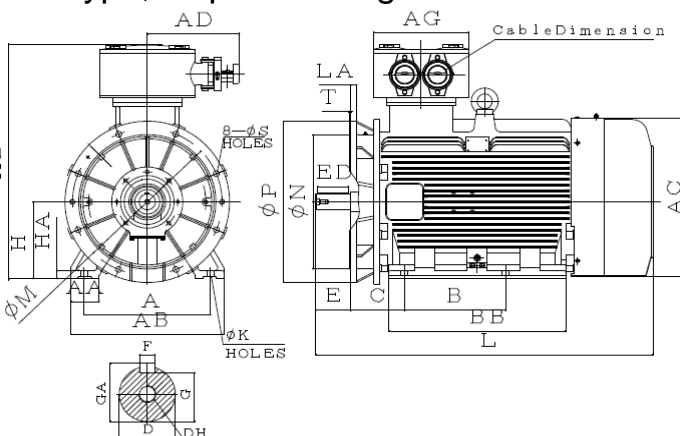

FIG.7

Dimensions in mm

Output (kW)					FRAME	FLANGE DIMENSION						A	AA	AB	AC	AD	AG	B	BB	C
2P	4P	6P	8P	SIZE		LA	M	N	P	S	T									
55	55	37	30		250M	22	500	450	550	18.5	5	406	85	480	542	320	310	349	509	168
75	75	45	37		280S							457	85	535	630			368	546	190
90	90	55	45		280M													419	586	
110	110	75	55		315S	25	600	550	660	24	6	508	115	615	686	370	380	406	710	216
132	132	90	75	315M	457													810		

FRAME SIZE	FIG. NO.	H	HA	HD	K	L	SHAFT EXTENSION							BEARING		EXPORT WIRE SIZE of CABLE GLAND BODY	THE RANGE of outer DIAMETER of INLET CABLE	
							D	E	ED	F	G	GA	DH	DRIVE END	OPPOSITE DRIVE END			
250M	6	250	30	750	24	1005	(60) 65	140	125	18	(53) 58	(64) 69	M20X42	(6313C3) 6315C3	(6313C3) 6313C3	rubber sheath cable or M64x2 or NPT 2.5"	Ø24~Ø40	
280S		280	35	810		1161	(65) 75			(18) 20	(58) 67.5	(69) 79.5		(6314C3) 6318C3	(6314C3) 6316C3			
280M						1201	(65) 75			(18) 20	(58) 67.5	(69) 79.5		(6314C3) 6318C3	(6314C3) 6316C3			
315S	7	315	35	958	28	(1354) 1384	(65) 80	(140) 170	(125) 160	(18) 22	(58) 71	(69) 85	M20X40	(6316C3) 6320C3	(6314C3) 6316C3	rubber sheath cable or M64x2 or M63x1.5 or NPT 2.5"	Ø38~Ø58	
315M						(1454) 1484												

Note : 1. Tolerance of Shaft End Diameter D : m6 . 2. Tolerance of N : 1)Fr#250M~280M:j6. 2)Fr#315S~315M:js6.
3. Tolerance of shaft center height H : 1)For #250, +0,-0.5; 2)For #280,315, +0,-1.
4. No . In () is for 2P.

APPD.	Sean	30-Jun-23	TECO Electric & Machinery Co., Ltd. Wuxi, China	DWG NO. 32057R9924
CHKD.	JOB	30-Jun-23		REV. 01
DWN.	GGL	30-Jun-23		

ISSUED	OUTLINE DIMENSIONS SHEET	MODEL
30-Jun-23		TEB5
REVISED	FLAMEPROOF MOTORS Ex db	PAGE
26-Dec-23	B35 (IM 2001) FRAME NOS. 315L ~ 355L	20 of 52

Totally Enclosed Fan - Cooled Type, Squirrel - Cage Rotor.

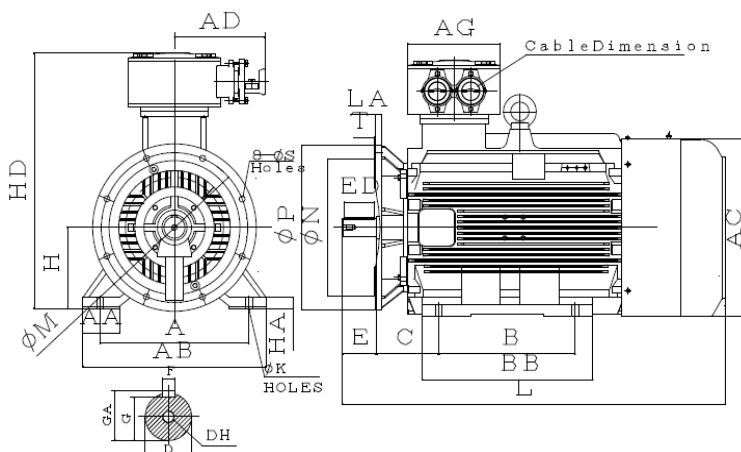

FIG.8

Dimensions in mm

Output (kW)					FRAME	FLANGE DIMENSION						A	AA	AB	AC	AD	AG	B	BB	C						
2P	4P	6P	8P	SIZE		LA	M	N	P	S	T															
160	160	110	90	315L	25	600	550	660	24	6	508	115	615	686	370	380	508	810	216							
185	185	132	110																							
200	200	—	—																							
220	220	160	132																							
250	250	200	160	355M	30	740	680	800			610	150	750	750			560	700	254							
280	280	220	185	355L																						
315	315	250	200																							

FRAME SIZE	FIG. NO.	H	HA	HD	K	L	SHAFT EXTENSION							BEARING		EXPORT WIRE	THE RANGE of
							D	E	ED	F	G	GA	DH	DRIVE END	OPPOSITE	SIZE of CABLE	outer DIAMETER
															DRIVE END	GLAND BODY	of INLET CABLE
315L	7	315	35	958	28	(1454) 1484	(65) 80	(140) 170	(125) 160	(18) 22	(58) 71	(69) 85	M20X40	(6316C3) 6320C3	(6314C3) 6316C3	rubber sheath cable or M64x2 or M63x1.5 or NPT 2.5"	Ø38~Ø58
355M	8	355	45	1025		(1570) 1600	(75) 95			(20) 25	(67.5) 86	(79.5) 100	(M20X40) M24X48	(6317C3) 6322C3	(6317C3) 6322C3		
355L						(1620) 1650											

- Note :**
1. Tolerance of Shaft End Diameter D : m6 .
 2. No . In () is for 2P.
 3. Tolerance of N : js6 .
 4. Tolerance of shaft center height H : +0,-1.

APPD.	Sean	30-Jun-23	TECO Electric & Machinery Co., Ltd.	DWG NO.
CHKD.	JOB	30-Jun-23		32057R9924
DWN.	GGL	30-Jun-23		REV. 01 5/5

Wuxi, China

ISSUED 26-Dec-23	OUTLINE DIMENSIONS SHEET FLAMEPROOF MOTORS Ex db V1 (IM 3011) FRAME NOS. 80M~100L	MODEL TEB5
REVISED		PAGE 21 of 52

Totally Enclosed Fan - Cooled Type, Squirrel - Cage Rotor.

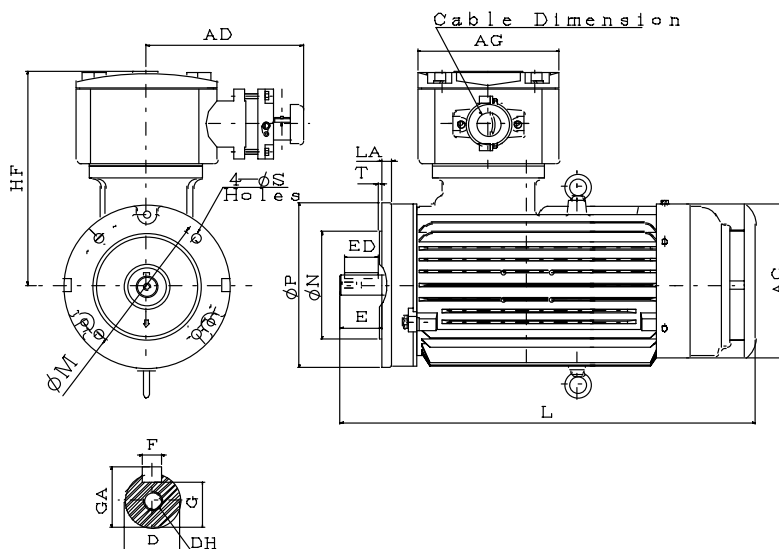

FIG.1

Dimensions in mm

Output (kW)				FRAME SIZE	FLANGE DIMENSION						AC	HF	AD	AG	L
2P	4P	6P	8P		LA	M	N	P	S	T					
0.75	-	-	0.18	80M	12	165	130	200	12	3.5	175	246			415
1.1	0.75	-	0.25												
1.5	1.1	0.75	0.37	90L							202	260	187.5	169	500
2.2	1.5	1.1	0.55												
3	2.2	1.5	0.75	100L	16	215	180	250	14.5	4	216	275			538
	3		1.1												

FRAME SIZE	FIG. NO.	SHAFT EXTENSION							BEARING		EXPORT WIRE	THE RANGE of outer DIAMETER of INLET CABLE
		D	E	ED	F	G	GA	DH	DRIVE END	OPPOSITE DRIVE END	SIZE of CABLE GLAND BODY	
80M	1	19	40	32	6	15.5	21.5	M6X16	6204ZZC3	6204ZZC3	rubber sheath cable or M30x2 or NPT 1"	Ø13~Ø22
90L		24	50	40	8	20	27	M8X19	6205ZZC3	6205ZZC3		
100L		28	60	50		24	31	M10X22	6206ZZC3	6206ZZC3		

Note : 1. Tolerance of Shaft End Diameter D : j6 .
2. Tolerance of N : j6 .

APPD.	Sean	26-Dec-23	TECO Electric & Machinery Co., Ltd. Wuxi, China	DWG NO.
CHKD.	JOB	26-Dec-23		32057R9925
DWN.	LHZ	26-Dec-23		REV. 01

ISSUED 26-Dec-23	OUTLINE DIMENSIONS SHEET FLAMEPROOF MOTORS Ex db V1 (IM 3011) FRAME NOS. 112M~160L	MODEL TEB5
REVISED		PAGE 22 of 52

Totally Enclosed Fan - Cooled Type, Squirrel - Cage Rotor.

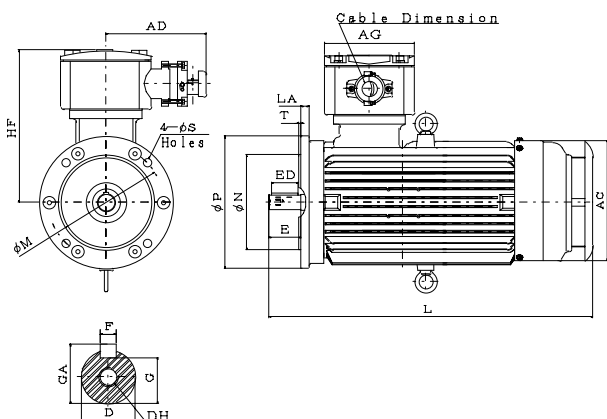

FIG.2

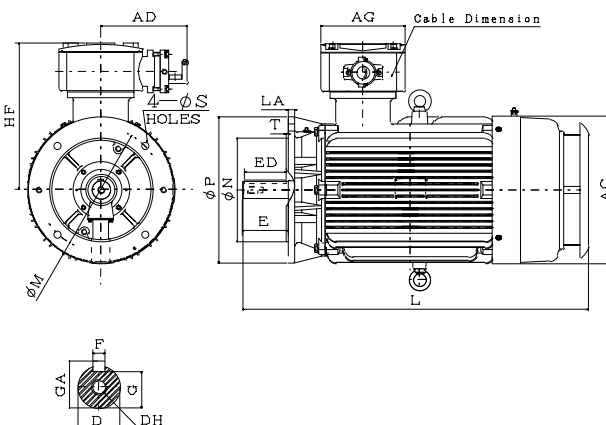

FIG.3

Dimensions in mm

Output (kW)				FRAME SIZE	FLANGE DIMENSION						AC	HF	AD	AG	L
2P	4P	6P	8P		LA	M	N	P	S	T					
4	4	2.2	1.5	112M	15	215	180	250			240	288			601
5.5	5.5	3	2.2	132S	16	265	230	300	14.5	4	273	295	187.5	169	605
7.5															
	7.5	4	3	132M											641
		5.5													
11	11	7.5	4	160M		300	250	350	18.5	5	355	352	209	202	813
15		5.5													
18.5	15	11	7.5	160L											

FRAME SIZE	FIG. NO.	SHAFT EXTENSION							BEARING		EXPORT WIRE	THE RANGE of	
		D	E	ED	F	G	GA	DH	DRIVE END	OPPOSITE DRIVE END	SIZE of CABLE GLAND BODY	outer DIAMETER of INLET CABLE	
112M	2	28	60	50	8	24	31	M10X22	6306ZZC3	6306ZZC3	rubber	Ø13~Ø22	
132S		38	80	70	10	33	41	M12X28	6308ZZC3	6306ZZC3	sheath cable or M30x2 or NPT1"		
132M													
160M	3	42	110	100	12	37	45	M16X36	6309C3	6307C3	rubber sheath cable or M36x2 or NPT 1.25"	Ø13~Ø28	
160L													

Note : 1. Tolerance of Shaft End Diameter D : 1) F#112 M : j6. 2) F#132S~160L : k6.
2. Tolerance of N : j6 .

APPD.	Sean	26-Dec-23	TECO Electric & Machinery Co., Ltd. Wuxi, China	DWG NO. 32057R9925 REV. 01
CHKD.	JOB	26-Dec-23		
DWN.	LHZ	26-Dec-23		

ISSUED	OUTLINE DIMENSIONS SHEET	MODEL
26-Dec-23		TEB5
REVISED	FLAMEPROOF MOTORS Ex db	PAGE
	V1 (IM 3011) FRAME NOS. 180M~225M	23 of 52

Totally Enclosed Fan - Cooled Type, Squirrel - Cage Rotor.

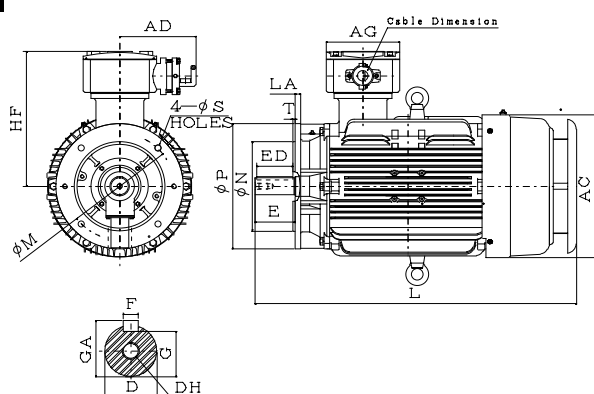

FIG.4

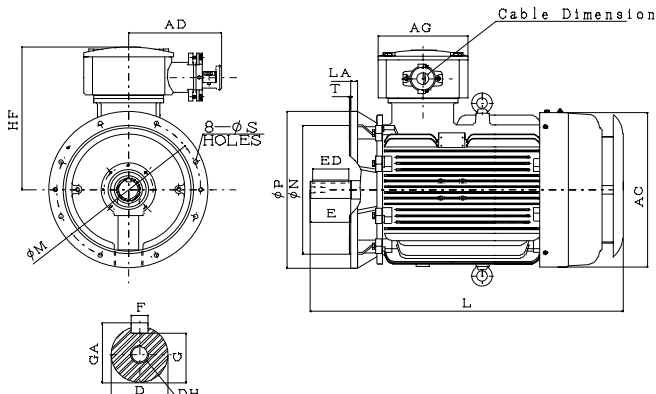

FIG.5

Dimensions in mm

Output (kW)				FRAME	FLANGE DIMENSION						AC	HF	AD	AG	L
2P	4P	6P	8P	SIZE	LA	M	N	P	S	T					
22	18.5	—	—	180M	16	300	250	350	18.5	5	400	377	209	202	864
—	22	15	11	180L							448	422	256	235	(976) 1006
30	30	18.5	15	200L	17	350	300	400							
37		22													
—	37	—	18.5	225M	20	400	350	450			498	447			
45	45	30	22												

FRAME SIZE	FIG. NO.	SHAFT EXTENSION							BEARING		EXPORT WIRE SIZE of CABLE GLAND BODY	THE RANGE of outer DIAMETER of INLET CABLE
		D	E	ED	F	G	GA	DH	DRIVE END	OPPOSITE DRIVE END		
180M	4	48	110	100	14	42.5	51.5	M16X36	6311C3	6310C3	rubber sheath cable or M36x2 or NPT 1.25"	Ø13~Ø28
180L												
200L	5	55	140	125	16	49	59	M20X42	6312C3	6212C3	rubber sheath cable or M48x2 or NPT 1.5" or NPT 2"	Ø19~ Ø37
225M		(55) 60			(16) 18	(49) 53	(59) 64	M20X42	(6312C3) 6313C3	(6212C3) 6213C3		

- Note :**
1. Tolerance of Shaft End Diameter D : 1) F#180 : k6. 2) F#200L~225M : m6.
 2. Tolerance of N : j6 .
 3. No. in () is for 2P.
 4. Fr#225 : When installing the flange,the mounting bolt must be threaded in from the customer side.

APPD.	Sean	26-Dec-23	TECO Electric & Machinery Co., Ltd.	DWG NO.
CHKD.	JOB	26-Dec-23		32057R9925
DWN.	LHZ	26-Dec-23		REV. 01 3/5

Wuxi, China

ISSUED 30-Jun-23	OUTLINE DIMENSIONS SHEET FLAMEPROOF MOTORS Ex db V1 (IM 3011) FRAME NOS. 250M ~315M	MODEL TEB5
REVISED 26-Dec-23		PAGE 24 of 52

Totally Enclosed Fan - Cooled Type, Squirrel - Cage Rotor.

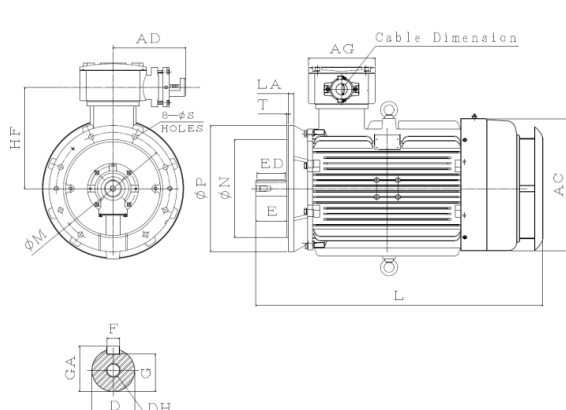

FIG.6

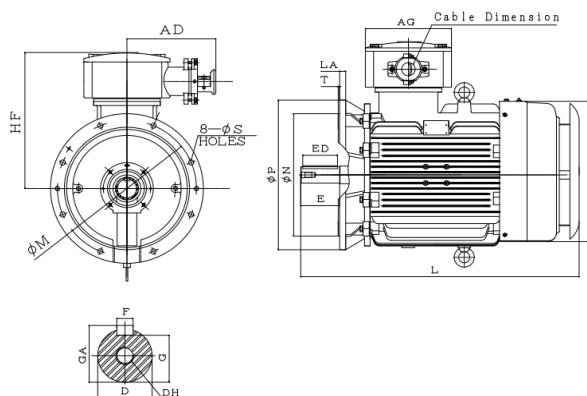

FIG.7

Dimensions in mm

Output (kW)				FRAME SIZE	FLANGE DIMENSION						AC	HF	AD	AG	L
2P	4P	6P	8P		LA	M	N	P	S	T					
55	55	37	30	250M	22	500	450	550	18.5	5	542	500	320	310	1080
75	75	45	37								630	530			1261
90	90	55	45												1301
110	110	75	55	315S	25	600	550	660	24	6	686	643	370	380	(1484) 1514
132	132	90	75	315M											(1584) 1614

FRAME SIZE	FIG. NO.	SHAFT EXTENSION							BEARING		EXPORT WIRE	THE RANGE of outer DIAMETER of INLET CABLE
		D	E	ED	F	G	GA	DH	DRIVE END	OPPOSITE DRIVE END	SIZE of CABLE GLAND BODY	
250M	6	(60) 65	140	125	18	(53) 58	(64) 69	M20X42	(6313C3) 6315C3	(6313C3) 6313C3	rubber sheath cable or M64X2 or NPT 2.5"	Ø 24~Ø 40
280S		(65) 75			(18) 20	(58) 67.5	(69) 79.5	M20X40	(6314C3) 6318C3	(6314C3) 6316C3		
280M												
315S	7	(65) 80	(140) 170	(125) 160	(18) 22	(58) 71	(69) 85		(6316C3) 6320C3	(6314C3) 6316C3	rubber sheath cable or M64x2 or M63X1.5 or NPT 2.5"	Ø38~Ø58
315M									(6316C3) 6320C3	(7314B) 7316B		

- Note :**
1. Tolerance of Shaft End Diameter D: m6.
 2. Tolerance of N : 1)Fr#250M~280M:j6. 2)Fr#315S~315M:js6.
 3. No. In () is for 2P.

APPD.	Sean	30-Jun-23	TECO Electric & Machinery Co., Ltd. Wuxi, China	DWG NO.
CHKD.	JOB	30-Jun-23		32057R9925
DWN.	GGL	30-Jun-23		REV. 01 4/5

ISSUED 30-Jun-23	OUTLINE DIMENSIONS SHEET FLAMEPROOF MOTORS Ex db V1 (IM 3011) FRAME NOS.315L ~ 355L	MODEL TEB5
REVISED 26-Dec-23		PAGE 25 of 52

Totally Enclosed Fan - Cooled Type, Squirrel - Cage Rotor.

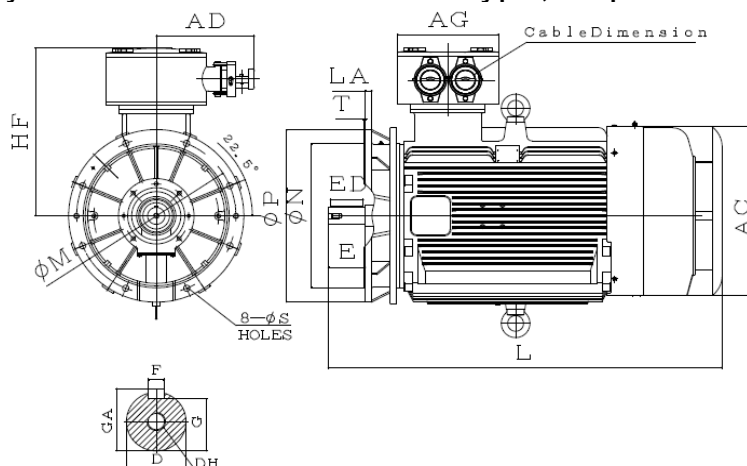

FIG.8

Dimensions in mm

Output (kW)					FRAME SIZE	FLANGE DIMENSION						AC	HF	AD	AG	L							
2P	4P	6P	8P			LA	M	N	P	S	T												
160	160	110	90		315L	25	600	550	660	24	6	686	643	370	380	(1584 1614							
185	185	132	110													355M	30	740	680	800	750	670	(1720 1750
200	200	—	—																				
220	220	160	132																				
250	250	200	160																				
280	280	220	185																				
315	315	250	200																				

FRAME SIZE	FIG. NO.	SHAFT EXTENSION							BEARING		EXPORT WIRE SIZE of CABLE GLAND BODY	THE RANGE of outer DIAMETER of INLET CABLE
		D	E	ED	F	G	GA	DH	DRIVE END	OPPOSITE DRIVE END		
315L	8	(65) 80	(140) 170	(125) 160	(18) 22	(58) 71	(69) 85	M20X40	(6316C3) 6320C3	(7314B) 7316B	rubber sheath cable or M64x2 or M63X1.5 or NPT 2.5"	Ø 38~Ø 58
355M		(75) 95			(20) 25	(67.5) 86	(79.5) 100	(M20X40) M24X48	(6317C3) 6322C3	(7317B) 7322B		
355L												

Note : 1. Tolerance of Shaft End Diameter D: m6.

2. Tolerance of N : js6 .

3. No . In () is for 2P.

APPD.	Sean	30-Jun-23	TECO Electric & Machinery Co., Ltd. Wuxi, China	DWG NO.
CHKD.	JOB	30-Jun-23		32057R9925
DWN.	GGL	30-Jun-23		REV. 01 5/5

ISSUED 30-Jun-23	SCHEMATIC DRAWING FLAMEPROOF MOTORS Ex db B3 (IM 1001) FRAME NOS. 80M~100L	MODEL TEB5
REVISED 26-Dec-23		PAGE 26 of 52

Totally Enclosed Fan - Cooled Type, Squirrel - Cage Rotor.

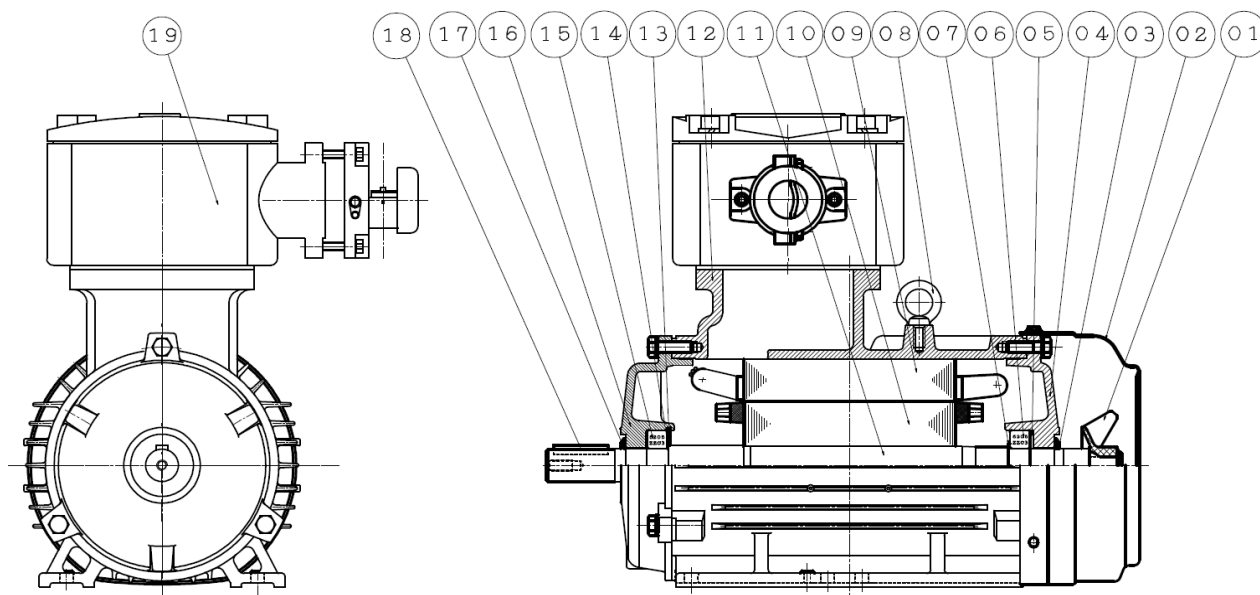

ITEM	NAME	ITEM	NAME
1	EXTERNAL FAN	11	SHAFT
2	FAN COVER	12	FRAME
3	GAMMA SEAL	13	INNER RETAINING RING
4	END BRACKET	14	STOP RING-BEARING
5	PRE-LOAD SPRING	15	BEARING
6	BEARING	16	END BRACKET
7	STOP RING-BEARING	17	GAMMA SEAL
8	EYE BOLT	18	KEY
9	STATOR	19	TERMINAL BOX ASSY
10	ROTOR		

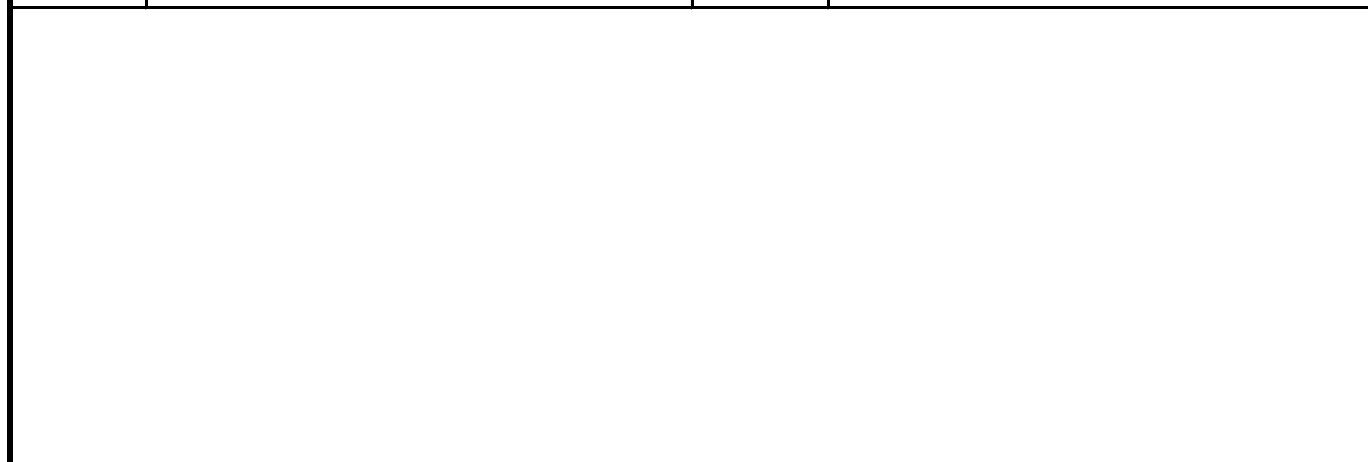

APPD.	Sean	30-Jun-23	TECO Electric & Machinery Co., Ltd. Wuxi, China	DWG NO.	32057R9926 REV. 01
CHKD.	JOB	30-Jun-23			
DWN.	GGL	30-Jun-23			

ISSUED 30-Jun-23	SCHEMATIC DRAWING FLAMEPROOF MOTORS Ex db B3 (IM 1001) FRAME NOS. 112M	MODEL TEB5
REVISED 26-Dec-23		PAGE 27 of 52

Totally Enclosed Fan - Cooled Type, Squirrel - Cage Rotor.

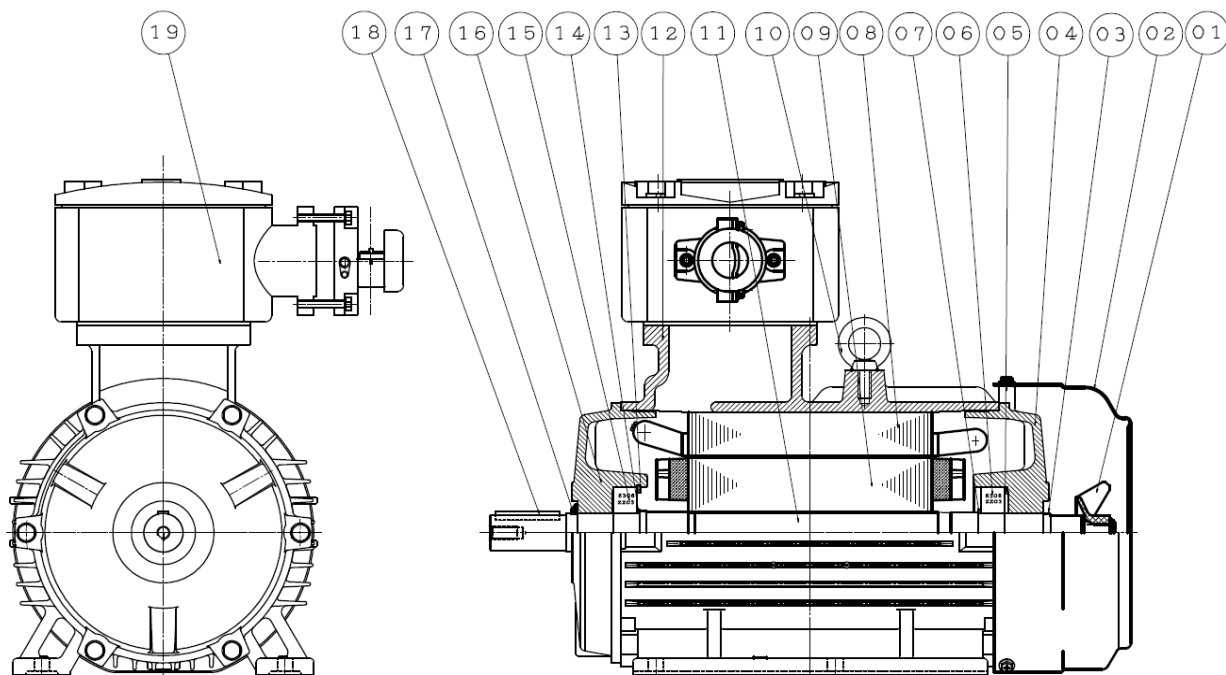

ITEM	NAME	ITEM	NAME
1	EXTERNAL FAN	11	SHAFT
2	FAN COVER	12	FRAME
3	GAMMA SEAL	13	INNER RETAINING RING
4	END BRACKET	14	STOP RING-BEARING
5	PRE-LOAD SPRING	15	BEARING
6	BEARING	16	END BRACKET
7	STOP RING-BEARING	17	GAMMA SEAL
8	STATOR	18	KEY
9	ROTOR	19	TERMINAL BOX ASSY
10	EYE BOLT		

APPD.	Sean	30-Jun-23	TECO Electric & Machinery Co., Ltd. Wuxi, China	DWG NO.
CHKD.	JOB	30-Jun-23		32057R9926
DWN.	GGL	30-Jun-23		REV. 01

ISSUED 30-Jun-23	SCHEMATIC DRAWING FLAMEPROOF MOTORS Ex db B3 (IM 1001) FRAME NOS. 132S~132M	MODEL TEB5
REVISED 26-Dec-23		PAGE 28 of 52

Totally Enclosed Fan - Cooled Type, Squirrel - Cage Rotor.

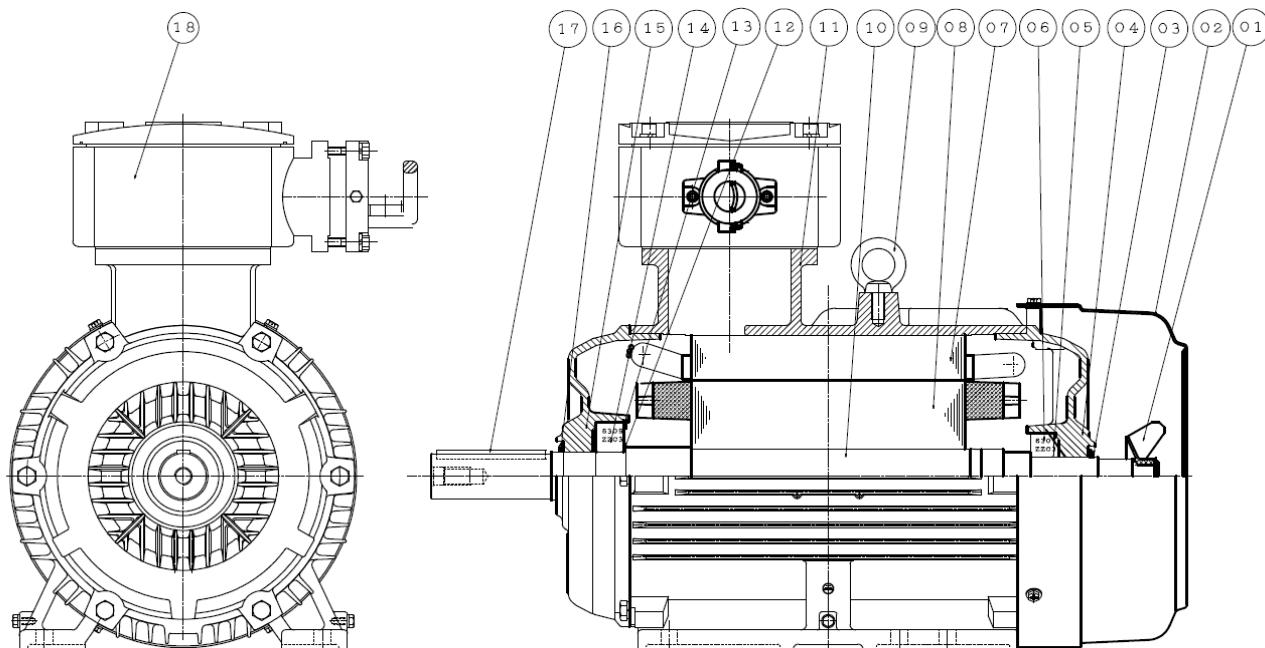

ITEM	NAME	ITEM	NAME
1	EXTERNAL FAN	14	BEARING
2	FAN COVER	15	END BRACKET
3	GAMMA SEAL	16	GAMMA SEAL
4	END BRACKET	17	KEY
5	PRE-LOAD SPRING	18	TERMINAL BOX ASSY
6	BEARING		
7	STATOR		
8	ROTOR		
9	EYE BOLT		
10	SHAFT		
11	FRAME		
12	STOP RING-BEARING		
13	INNER RETAINING RING		

APPD.	Sean	30-Jun-23	TECO Electric & Machinery Co., Ltd. Wuxi, China	DWG NO.
CHKD.	JOB	30-Jun-23		32057R9926
DWN.	GGL	30-Jun-23		REV. 01
				3/7

ISSUED 30-Jun-23	SCHEMATIC DRAWING FLAMEPROOF MOTORS Ex db B3 (IM 1001) FRAME NOS. 160M~250M	MODEL TEB5
REVISED 26-Dec-23		PAGE 29 of 52

Totally Enclosed Fan - Cooled Type, Squirrel - Cage Rotor.

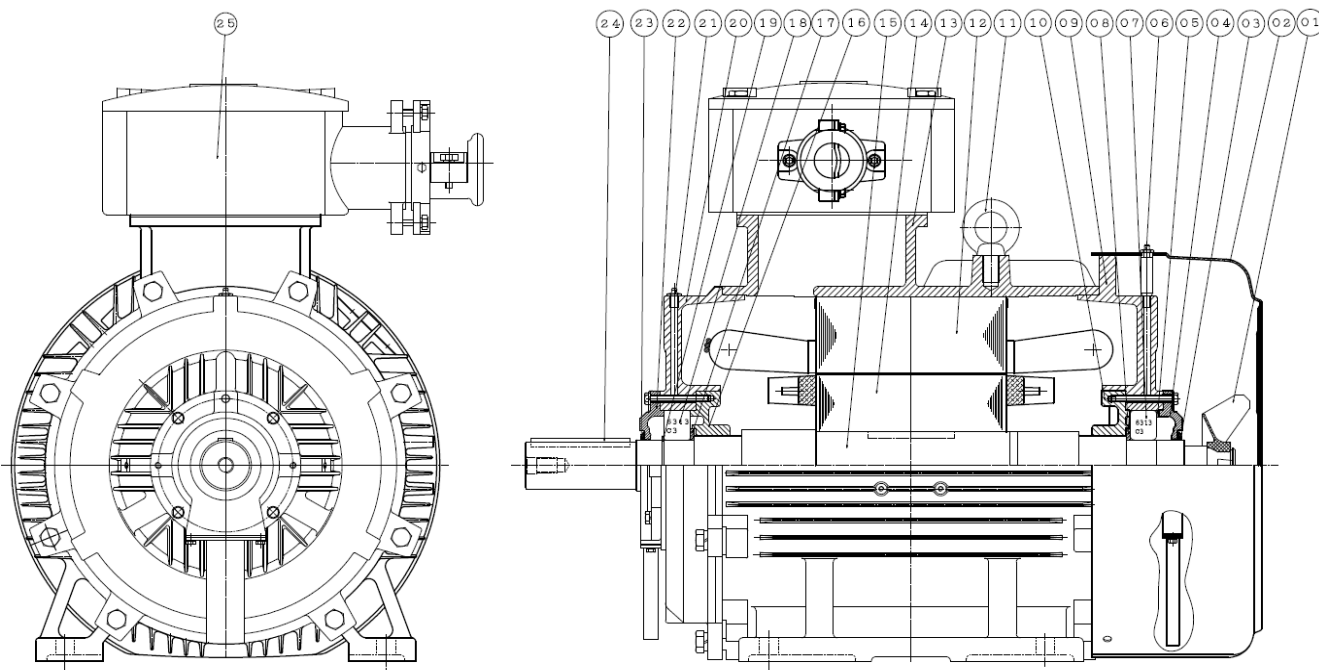

ITEM	NAME	ITEM	NAME
1	EXTERNAL FAN	16	BEARING COVER - INNER
2	FAN COVER	17	STOP RING-BEARING
3	GAMMA SEAL	18	BEARING
4	BEARING COVER - OUTER	19	OUTSIDE RETAINING RING
5	PRE - LOAD SPRING	20	END BRACKET
6	GREASE NIPPLE	21	GREASE NIPPLE
7	BEARING	22	BEARING COVER - OUTER
8	STOP RING-BEARING	23	GAMMA SEAL
9	END BRACKET	24	KEY
10	BEARING COVER - INNER	25	TERMINAL BOX ASSY
11	EYE BOLT		
12	STATOR		
13	FRAME		
14	ROTOR		
15	SHAFT		

APPD.	Sean	30-Jun-23	TECO Electric & Machinery Co., Ltd. Wuxi, China	DWG NO.
CHKD.	JOB	30-Jun-23		32057R9926
DWN.	GGL	30-Jun-23		REV. 01

ISSUED 30-Jun-23	SCHEMATIC DRAWING FLAMEPROOF MOTORS Ex db B3 (IM 1001) FRAME NOS.280S~280M	MODEL TEB5
REVISED 26-Dec-23		PAGE 30 of 52

Totally Enclosed Fan - Cooled Type, Squirrel - Cage Rotor.

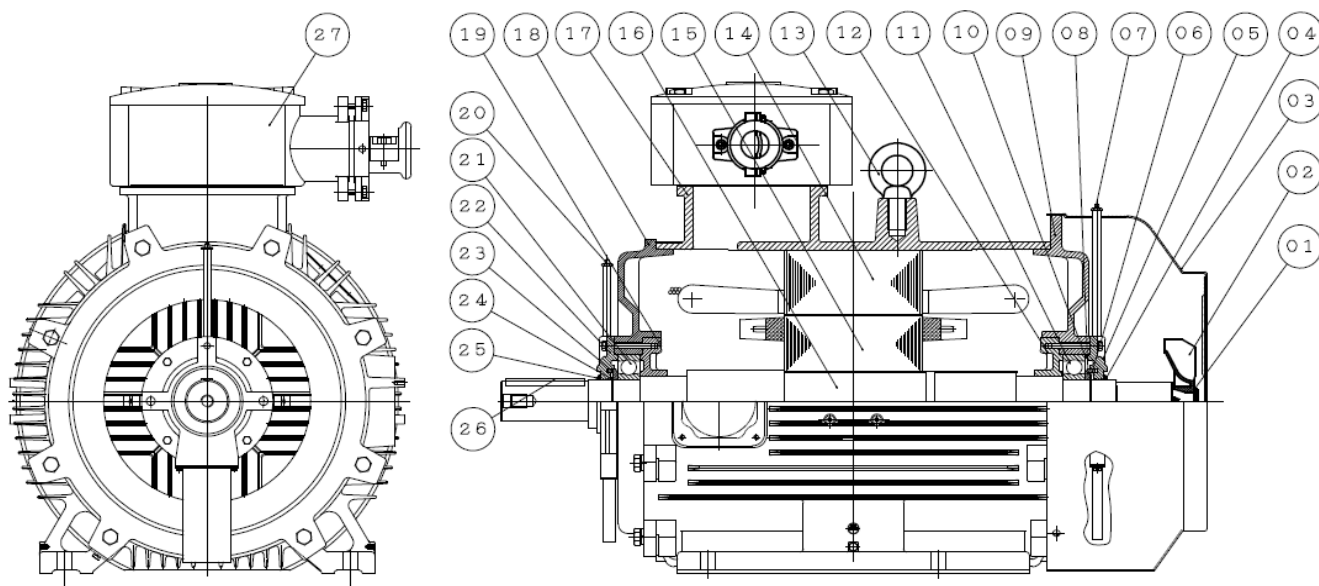

ITEM	NAME	ITEM	NAME
1	OUTSIDE RETAINING RING	16	SHAFT
2	EXTERNAL FAN	17	FRAME
3	FAN COVER	18	END BRACKET
4	GAMMA SEAL	19	BEARING COVER - INNER
5	BEARING COVER - OUTER	20	GREASE NIPPLE
6	OUTSIDE RETAINING RING	21	BEARING
7	GREASE NIPPLE	22	BEARING COVER - OUTER
8	GREASE FLINGER	23	GREASE FLINGER
9	END BRACKET	24	OUTSIDE RETAINING RING
10	PRE - LOAD SPRING	25	GAMMA SEAL
11	BEARING	26	KEY
12	BEARING COVER - INNER	27	TERMINAL BOX ASSY
13	EYE BOLT		
14	STATOR		
15	ROTOR		

APPD.	Sean	30-Jun-23	TECO Electric & Machinery Co., Ltd. Wuxi, China	DWG NO.	32057R9926
CHKD.	JOB	30-Jun-23		REV. 01	
DWN.	GGL	30-Jun-23		5/7	

ISSUED 30-Jun-23	SCHEMATIC DRAWING FLAMEPROOF MOTORS Ex db B3 (IM 1001) FRAME NOS.315	MODEL TEB5
REVISED 26-Dec-23		PAGE 31 of 52

Totally Enclosed Fan - Cooled Type, Squirrel - Cage Rotor.

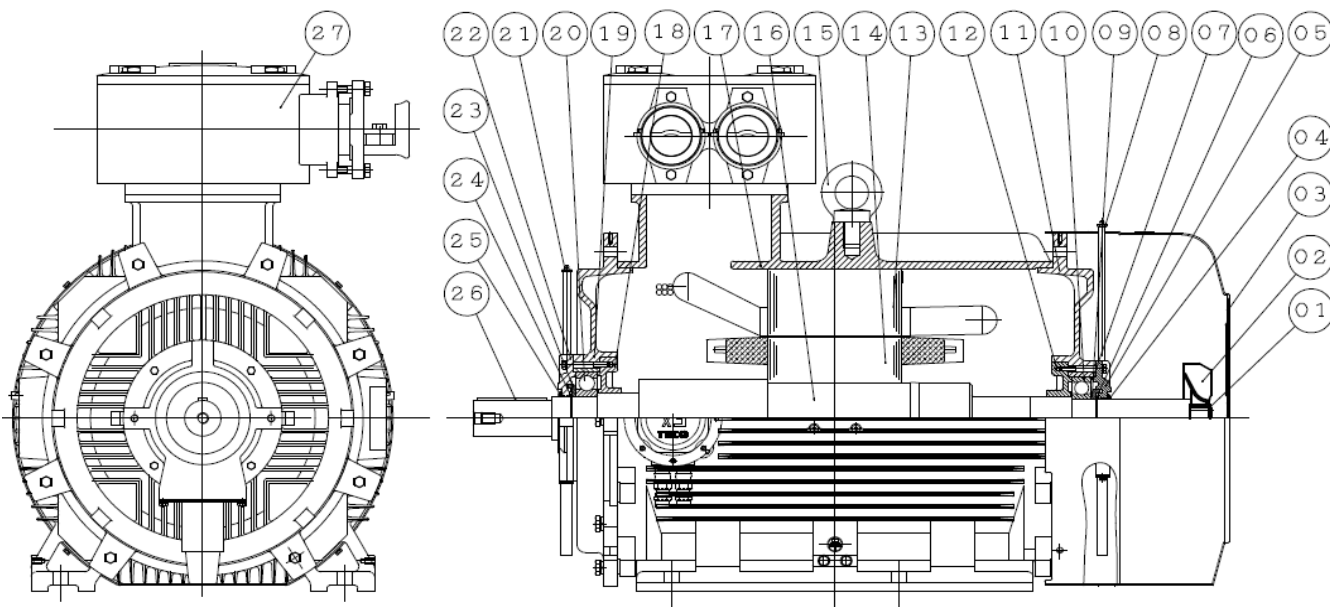

ITEM	NAME	ITEM	NAME
1	OUTSIDE RETAINING RING	16	SHAFT
2	EXTERNAL FAN	17	FRAME
3	FAN COVER	18	BEARING COVER - INNER
4	GAMMA SEAL	19	END BRACKET
5	BEARING COVER - OUTER	20	BEARING
6	OUTSIDE RETAINING RING	21	GREASE NIPPLE
7	PRE - LOAD SPRING	22	BEARING COVER - OUTER
8	GREASE NIPPLE	23	GREASE FLINGER
9	GREASE FLINGER	24	OUTSIDE RETAINING RING
10	BEARING	25	GAMMA SEAL
11	END BRACKET	26	KEY
12	BEARING COVER - INNER	27	TERMINAL BOX ASSY
13	STATOR		
14	ROTOR		
15	EYE BOLT		

APPD.	Sean	30-Jun-23	TECO Electric & Machinery Co., Ltd. Wuxi, China	DWG NO.	32057R9926
CHKD.	JOB	30-Jun-23		REV. 01	
DWN.	GGL	30-Jun-23		6/7	

ISSUED 30-Jun-23	SCHEMATIC DRAWING FLAMEPROOF MOTORS Ex db B3 (IM 1001) FRAME NOS.355	MODEL TEB5
REVISED 26-Dec-23		PAGE 32 of 52

Totally Enclosed Fan - Cooled Type, Squirrel - Cage Rotor.

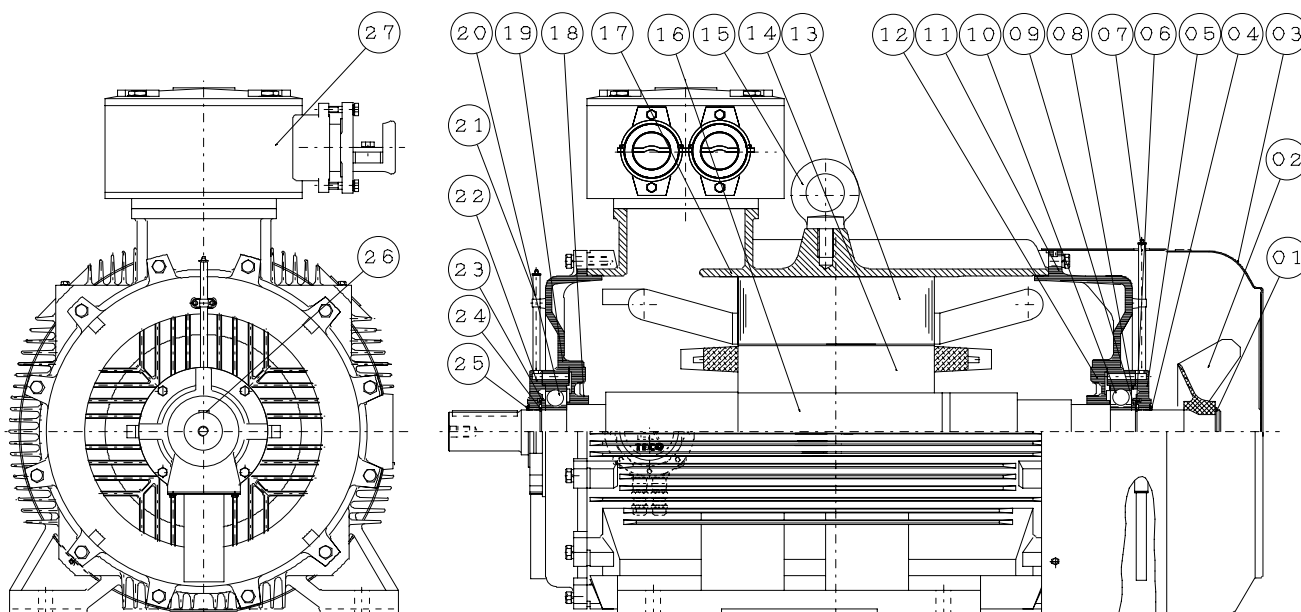

ITEM	NAME	ITEM	NAME
1	OUTSIDE RETAINING RING	16	SHAFT
2	EXTERNAL FAN	17	FRAME
3	FAN COVER	18	BEARING COVER - INNER
4	GAMMA SEAL	19	END BRACKET
5	BEARING COVER - OUTER	20	BEARING
6	OUTSIDE RETAINING RING	21	GREASE NIPPLE
7	GREASE NIPPLE	22	BEARING COVER - OUTER
8	PRE - LOAD SPRING	23	GREASE FLINGER
9	GREASE FLINGER	24	OUTSIDE RETAINING RING
10	BEARING	25	GAMMA SEAL
11	END BRACKET	26	KEY
12	BEARING COVER - INNER	27	TERMINAL BOX ASSY
13	STATOR		
14	ROTOR		
15	EYE BOLT		

APPD.	Sean	30-Jun-23	TECO Electric & Machinery Co., Ltd. Wuxi, China	DWG NO.
CHKD.	JOB	30-Jun-23		32057R9926
DWN.	GGL	30-Jun-23		REV. 01

ISSUED	SCHEMATIC DRAWING	MODEL
26-Dec-23		TEB5
REVISED	FLAMEPROOF MOTORS Ex db	PAGE
	B5 (IM 3001) FRAME NOS. 80M~100L	33 of 52

Totally Enclosed Fan - Cooled Type, Squirrel - Cage Rotor.

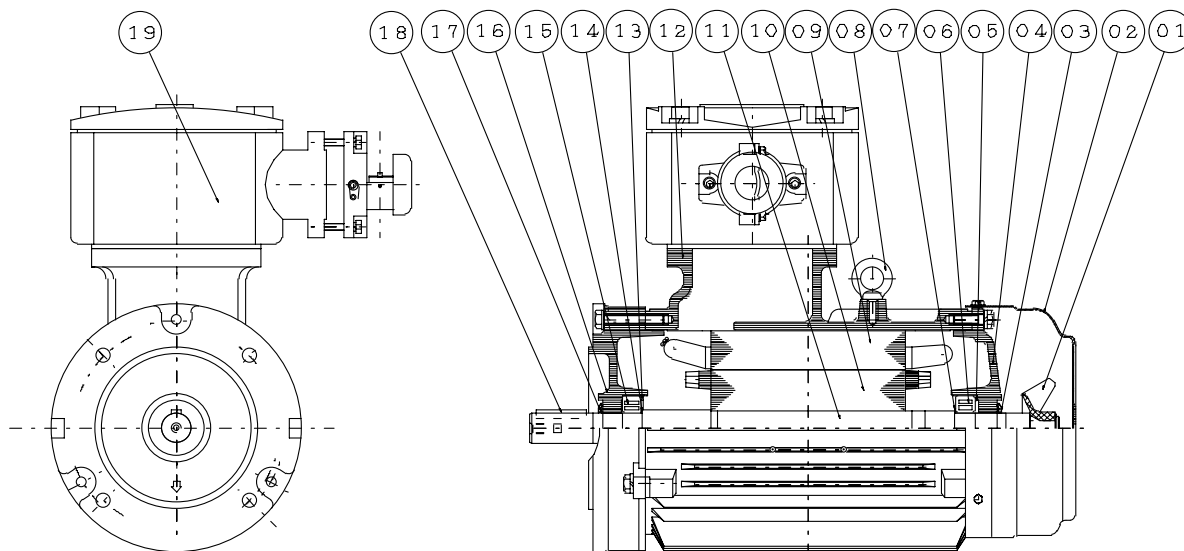

ITEM	NAME	ITEM	NAME
1	EXTERNAL FAN	11	SHAFT
2	FAN COVER	12	FRAME
3	GAMMA SEAL	13	INNER RETAINING RING
4	END BRACKET	14	STOP RING-BEARING
5	PRE-LOAD SPRING	15	BEARING
6	BEARING	16	FLANGE
7	STOP RING-BEARING	17	GAMMA SEAL
8	EYE BOLT	18	KEY
9	STATOR	19	TERMINAL BOX ASSY
10	ROTOR		

APPD.	Sean	26-Dec-23	TECO Electric & Machinery Co., Ltd. Wuxi, China	DWG NO.
CHKD.	JOB	26-Dec-23		32057R9927
DWN.	LHZ	26-Dec-23		REV. 01
				1/5

ISSUED	SCHEMATIC DRAWING	MODEL
26-Dec-23		TEB5
REVISED	FLAMEPROOF MOTORS Ex db	PAGE
	B5 (IM 3001) FRAME NOS. 112M	34 of 52

Totally Enclosed Fan - Cooled Type, Squirrel - Cage Rotor.

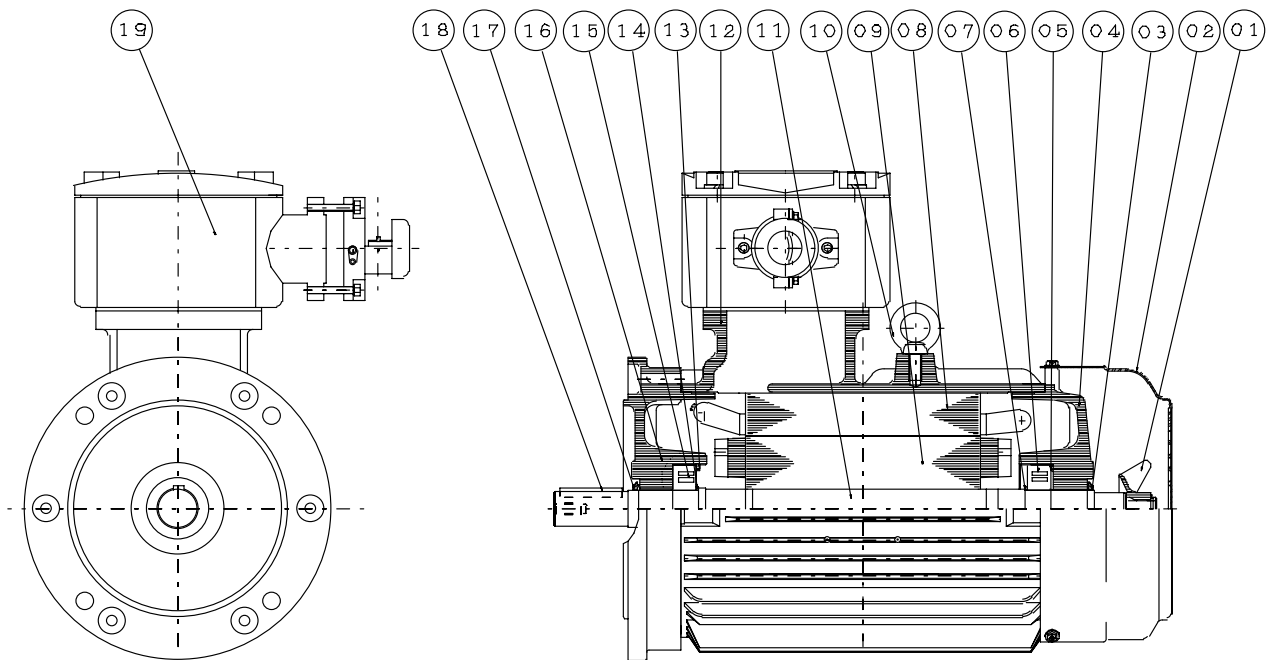

ITEM	NAME	ITEM	NAME
1	EXTERNAL FAN	11	SHAFT
2	FAN COVER	12	FRAME
3	GAMMA SEAL	13	INNER RETAINING RING
4	END BRACKET	14	STOP RING-BEARING
5	PRE-LOAD SPRING	15	BEARING
6	BEARING	16	FLANGE
7	STOP RING-BEARING	17	GAMMA SEAL
8	STATOR	18	KEY
9	ROTOR	19	TERMINAL BOX ASSY
10	EYE BOLT		

APPD.	Sean	26-Dec-23	TECO Electric & Machinery Co., Ltd.	DWG NO.
CHKD.	JOB	26-Dec-23		32057R9927
DWN.	LHZ	26-Dec-23		REV. 01
			Wuxi, China	2/5

ISSUED	SCHEMATIC DRAWING	MODEL
26-Dec-23		TEB5
REVISED	FLAMEPROOF MOTORS Ex db	PAGE
	B5 (IM 3001) FRAME NOS. 132S~132M	35 of 52

Totally Enclosed Fan - Cooled Type, Squirrel - Cage Rotor.

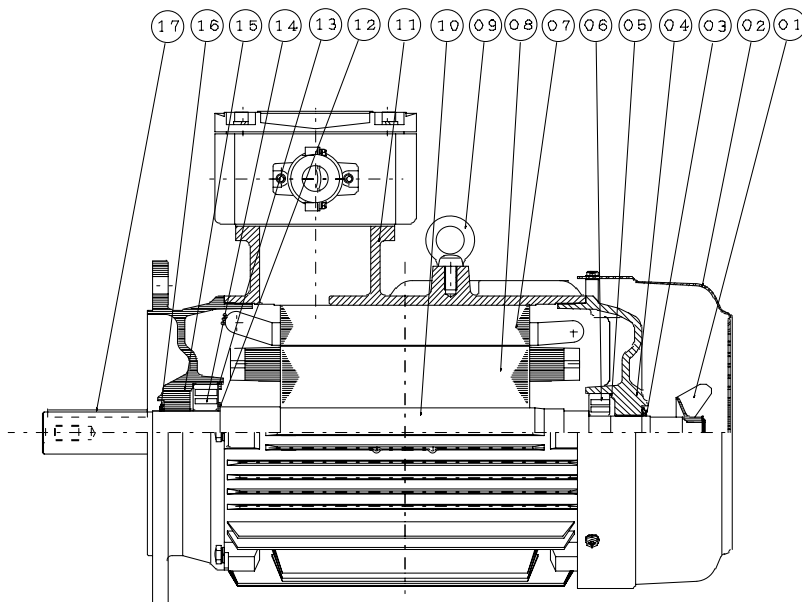
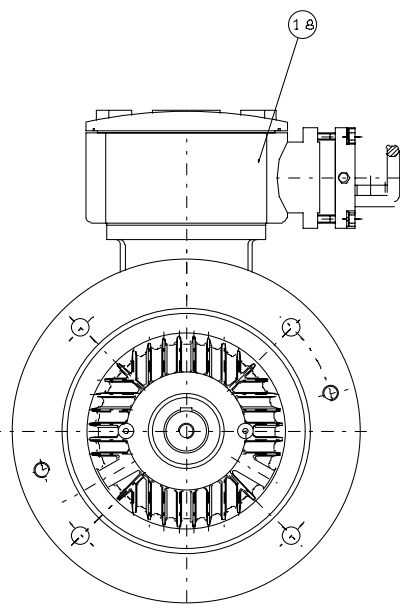

ITEM	NAME	ITEM	NAME
1	EXTERNAL FAN	14	BEARING
2	FAN COVER	15	FLANGE
3	GAMMA SEAL	16	GAMMA SEAL
4	END BRACKET	17	KEY
5	PRE-LOAD SPRING	18	TERMINAL BOX ASSY
6	BEARING		
7	STATOR		
8	ROTOR		
9	EYE BOLT		
10	SHAFT		
11	FRAME		
12	STOP RING-BEARING		
13	INNER RETAINING RING		

APPD.	Sean	26-Dec-23	TECO Electric & Machinery Co., Ltd. Wuxi, China	DWG NO.
CHKD.	JOB	26-Dec-23		32057R9927
DWN.	LHZ	26-Dec-23		REV. 01
				3/5

ISSUED	SCHEMATIC DRAWING	MODEL
26-Dec-23		TEB5
REVISED	FLAMEPROOF MOTORS Ex db	PAGE
	B5 (IM 3001) FRAME NOS. 160M~250M	36 of 52

Totally Enclosed Fan - Cooled Type, Squirrel - Cage Rotor.

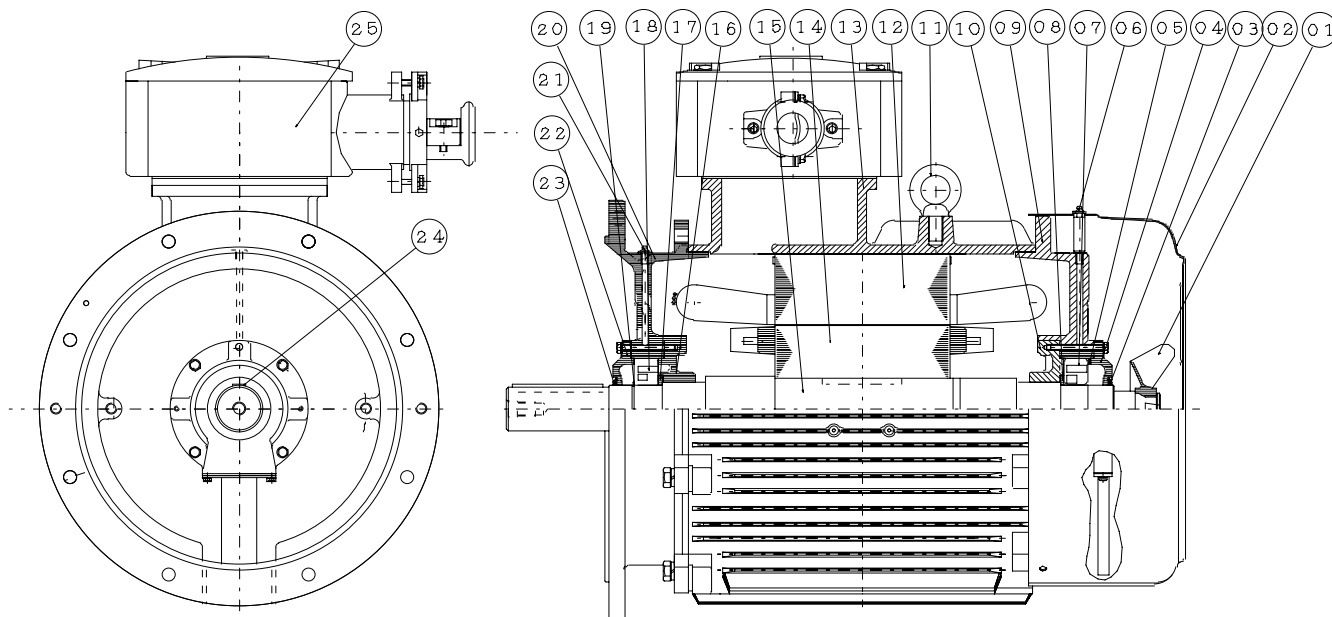

ITEM	NAME	ITEM	NAME
1	EXTERNAL FAN	16	BEARING COVER - INNER
2	FAN COVER	17	STOP RING-BEARING
3	GAMMA SEAL	18	BEARING
4	BEARING COVER - OUTER	19	OUTSIDE RETAINING RING
5	PRE - LOAD SPRING	20	FLANGE
6	GREASE NIPPLE	21	GREASE NIPPLE
7	BEARING	22	BEARING COVER - OUTER
8	STOP RING-BEARING	23	GAMMA SEAL
9	END BRACKET	24	KEY
10	BEARING COVER - INNER	25	TERMINAL BOX ASSY
11	EYE BOLT		
12	STATOR		
13	FRAME		
14	ROTOR		
15	SHAFT		

APPD.	Sean	26-Dec-23	TECO Electric & Machinery Co., Ltd. Wuxi, China	DWG NO.	32057R9927
CHKD.	JOB	26-Dec-23		REV. 01	
DWN.	LHZ	26-Dec-23		4/5	

ISSUED 30-Jun-23	SCHEMATIC DRAWING FLAMEPROOF MOTORS Ex db B5 (IM 3001) FRAME NOS. 280S~280M	MODEL TEB5
REVISED 26-Dec-23		PAGE 37 of 52

Totally Enclosed Fan - Cooled Type, Squirrel - Cage Rotor.

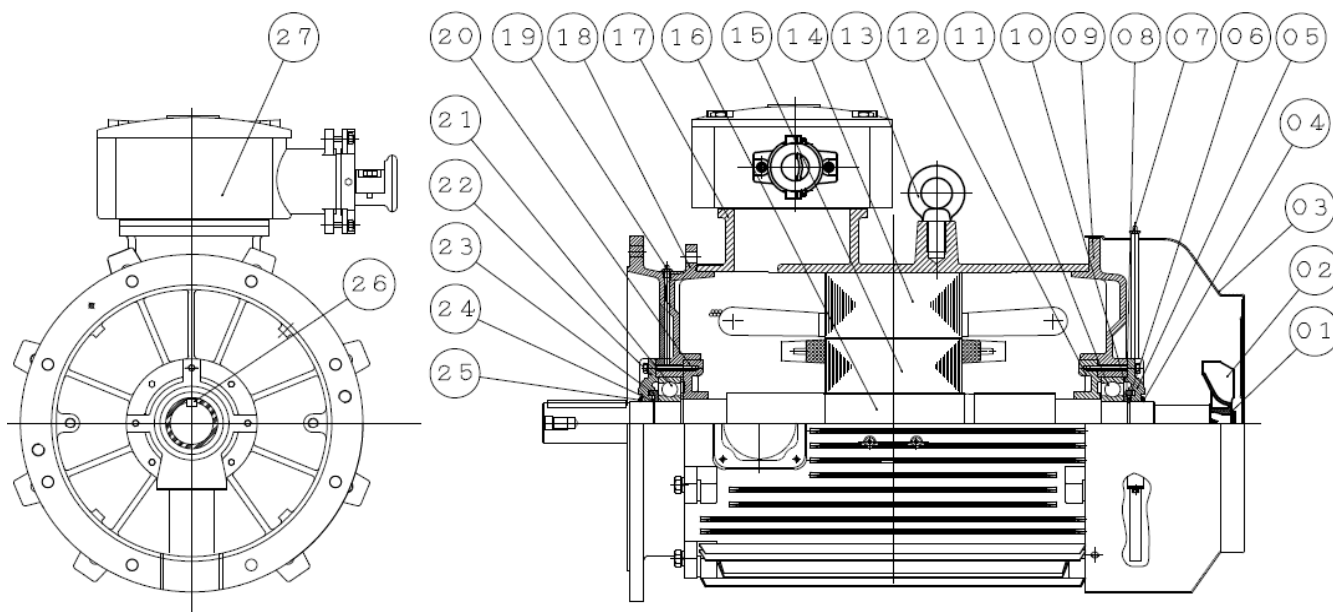

ITEM	NAME	ITEM	NAME
1	OUTSIDE RETAINING RING	16	SHAFT
2	EXTERNAL FAN	17	FRAME
3	FAN COVER	18	FLANGE
4	GAMMA SEAL	19	GREASE NIPPLE
5	BEARING COVER - OUTER	20	BEARING COVER - INNER
6	OUTSIDE RETAINING RING	21	BEARING
7	GREASE NIPPLE	22	BEARING COVER - OUTER
8	GREASE FLINGER	23	GREASE FLINGER
9	END BRACKET	24	OUTSIDE RETAINING RING
10	PRE - LOAD SPRING	25	GAMMA SEAL
11	BEARING	26	KEY
12	BEARING COVER - INNER	27	TERMINAL BOX ASSY
13	EYE BOLT		
14	STATOR		
15	ROTOR		

APPD.	Sean	30-Jun-23	TECO Electric & Machinery Co., Ltd. Wuxi, China	DWG NO.	32057R9927 REV. 01	5/5
CHKD.	JOB	30-Jun-23				
DWN.	GGL	30-Jun-23				

ISSUED 30-Jun-23	SCHEMATIC DRAWING FLAMEPROOF MOTORS Ex db B35 (IM 2001) FRAME NOS. 80M~100L	MODEL TEB5
REVISED 26-Dec-23		PAGE 38 of 52

Totally Enclosed Fan - Cooled Type, Squirrel - Cage Rotor.

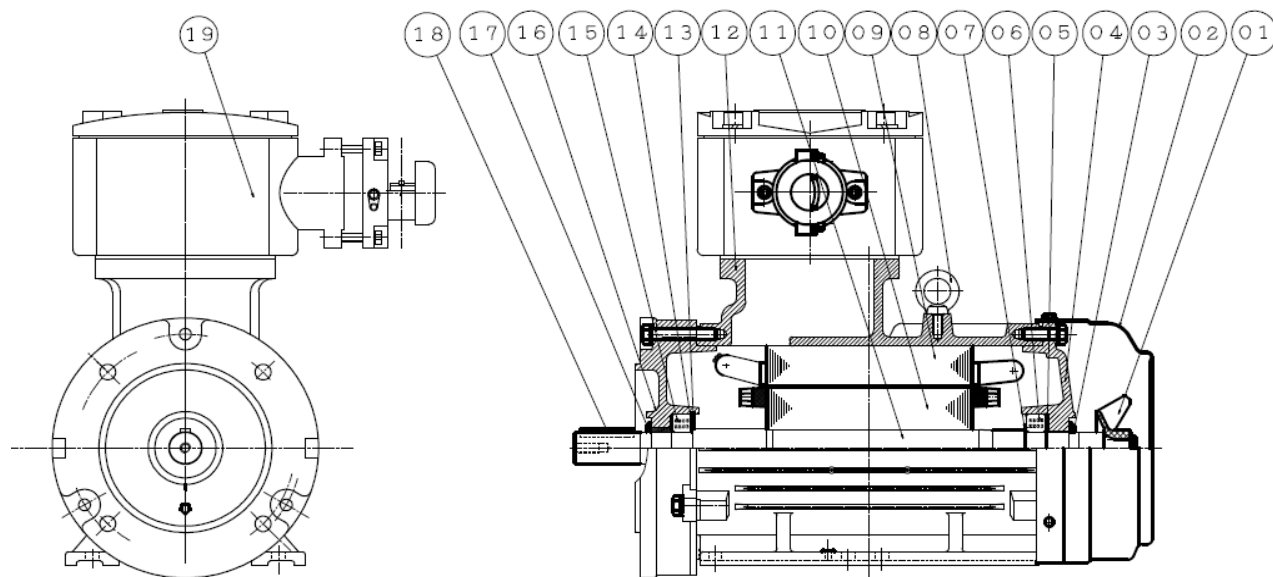

ITEM	NAME	ITEM	NAME
1	EXTERNAL FAN	11	SHAFT
2	FAN COVER	12	FRAME
3	GAMMA SEAL	13	INNER RETAINING RING
4	END BRACKET	14	STOP RING-BEARING
5	PRE-LOAD SPRING	15	BEARING
6	BEARING	16	FLANGE
7	STOP RING-BEARING	17	GAMMA SEAL
8	EYE BOLT	18	KEY
9	STATOR	19	TERMINAL BOX ASSY
10	ROTOR		

APPD.	Sean	30-Jun-23	TECO Electric & Machinery Co., Ltd. Wuxi, China	DWG NO.	32057R9928 REV. 01	1/8
CHKD.	JOB	30-Jun-23				
DWN.	GGL	30-Jun-23				

ISSUED 30-Jun-23	SCHEMATIC DRAWING FLAMEPROOF MOTORS Ex db B35 (IM 2001) FRAME NOS. 112M	MODEL TEB5
REVISED 26-Dec-23		PAGE 39 of 52

Totally Enclosed Fan - Cooled Type, Squirrel - Cage Rotor.

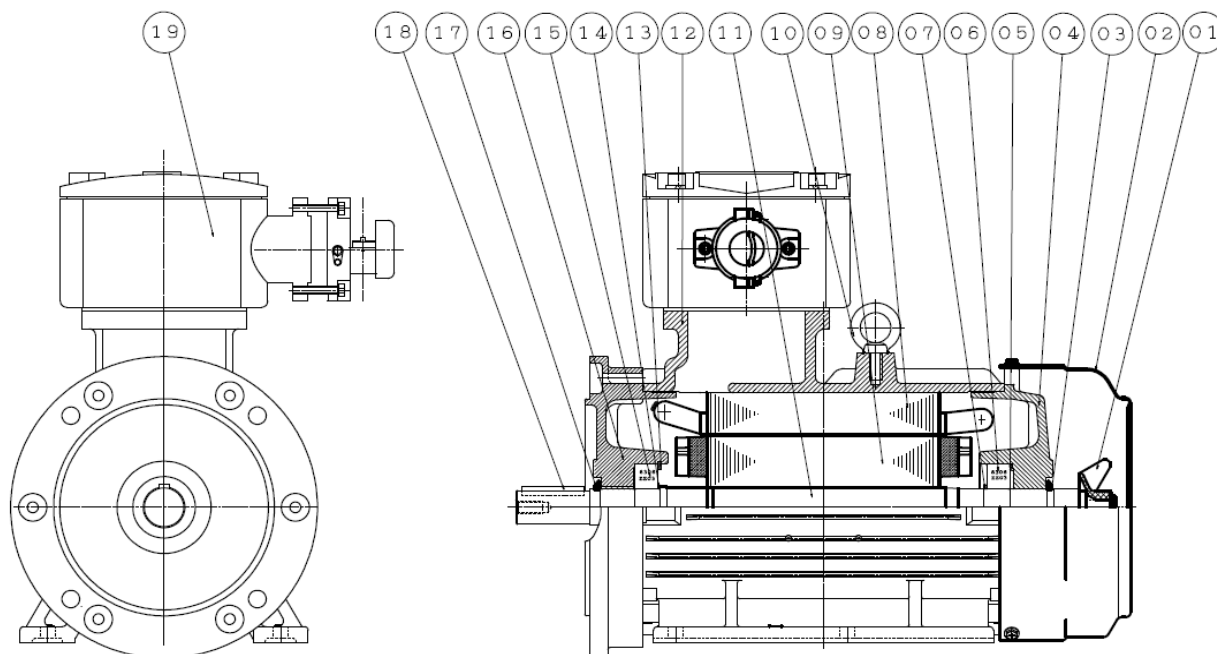

ITEM	NAME	ITEM	NAME
1	EXTERNAL FAN	11	SHAFT
2	FAN COVER	12	FRAME
3	GAMMA SEAL	13	INNER RETAINING RING
4	END BRACKET	14	STOP RING-BEARING
5	PRE-LOAD SPRING	15	BEARING
6	BEARING	16	FLANGE
7	STOP RING-BEARING	17	GAMMA SEAL
8	STATOR	18	KEY
9	ROTOR	19	TERMINAL BOX ASSY
10	EYE BOLT		

APPD.	Sean	30-Jun-23	TECO Electric & Machinery Co., Ltd. Wuxi, China	DWG NO.
CHKD.	JOB	30-Jun-23		32057R9928
DWN.	GGL	30-Jun-23		REV. 01

ISSUED 30-Jun-23	SCHEMATIC DRAWING FLAMEPROOF MOTORS Ex db B35 (IM 2001) FRAME NOS. 132S ~ 132M	MODEL TEB5
REVISED 26-Dec-23		PAGE 40 of 52

Totally Enclosed Fan - Cooled Type, Squirrel - Cage Rotor.

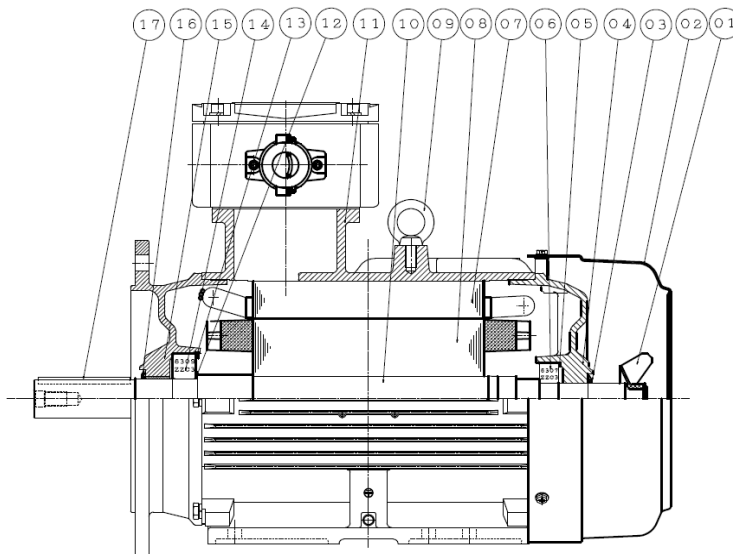
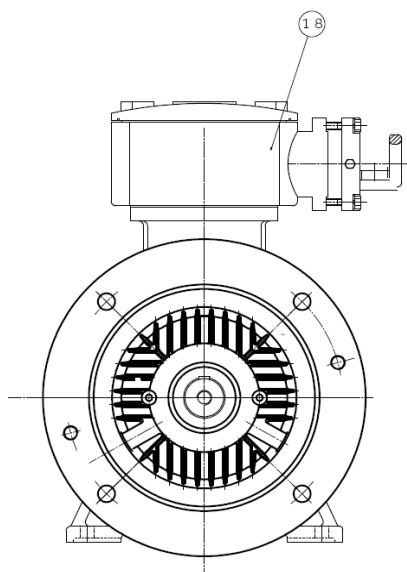

ITEM	NAME	ITEM	NAME
1	EXTERNAL FAN	14	BEARING
2	FAN COVER	15	FLANGE
3	GAMMA SEAL	16	GAMMA SEAL
4	END BRACKET	17	KEY
5	PRE-LOAD SPRING	18	TERMINAL BOX ASSY
6	BEARING		
7	STATOR		
8	ROTOR		
9	EYE BOLT		
10	SHAFT		
11	FRAME		
12	STOP RING-BEARING		
13	INNER RETAINING RING		

APPD.	Sean	30-Jun-23	TECO Electric & Machinery Co., Ltd. Wuxi, China	DWG NO.
CHKD.	JOB	30-Jun-23		32057R9928
DWN.	GGL	30-Jun-23		REV. 01
				3/8

ISSUED 30-Jun-23	SCHEMATIC DRAWING FLAMEPROOF MOTORS Ex db B35 (IM 2001) FRAME NOS. 160M-180L	MODEL TEB5
REVISED 26-Dec-23		PAGE 41 of 52

Totally Enclosed Fan - Cooled Type, Squirrel - Cage Rotor.

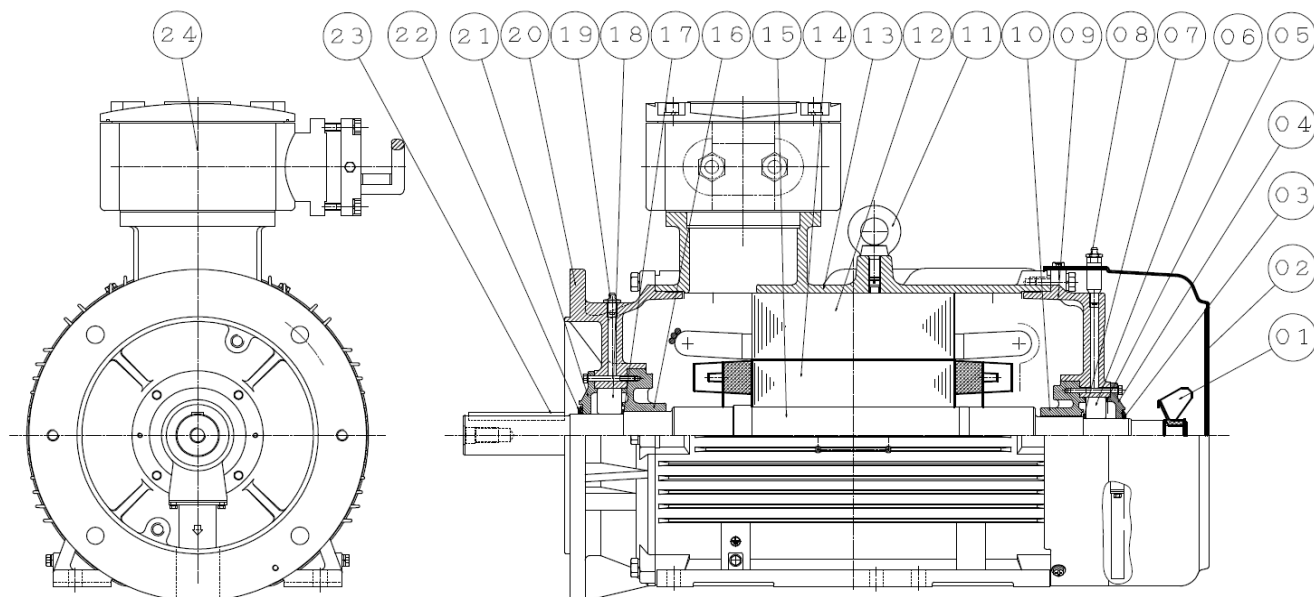

ITEM	NAME	ITEM	NAME
1	EXTERNAL FAN	15	SHAFT
2	FAN COVER	16	BEARING COVER - INNER
3	GAMMA SEAL	17	STOP RING-BEARING
4	BEARING COVER - OUTER	18	BEARING
5	PRE - LOAD SPRING	19	GREASE NIPPLE
6	BEARING	20	FLANGE
7	GREASE NIPPLE	21	BEARING COVER - OUTER
8	STOP RING-BEARING	22	GAMMA SEAL
9	END BRACKET	23	KEY
10	BEARING COVER - INNER	24	TERMINAL BOX ASSY
11	EYE BOLT		
12	STATOR		
13	FRAME		
14	ROTOR		

APPD.	Sean	30-Jun-23	TECO Electric & Machinery Co., Ltd. Wuxi, China	DWG NO.
CHKD.	JOB	30-Jun-23		32057R9928
DWN.	GGL	30-Jun-23		REV. 01
				4/8

ISSUED	SCHEMATIC DRAWING	MODEL
30-Jun-23		TEB5
REVISED	FLAMEPROOF MOTORS Ex db B35 (IM 2001) FRAME NOS. 200L~250M	PAGE
26-Dec-23		42 of 52

Totally Enclosed Fan - Cooled Type, Squirrel - Cage Rotor.

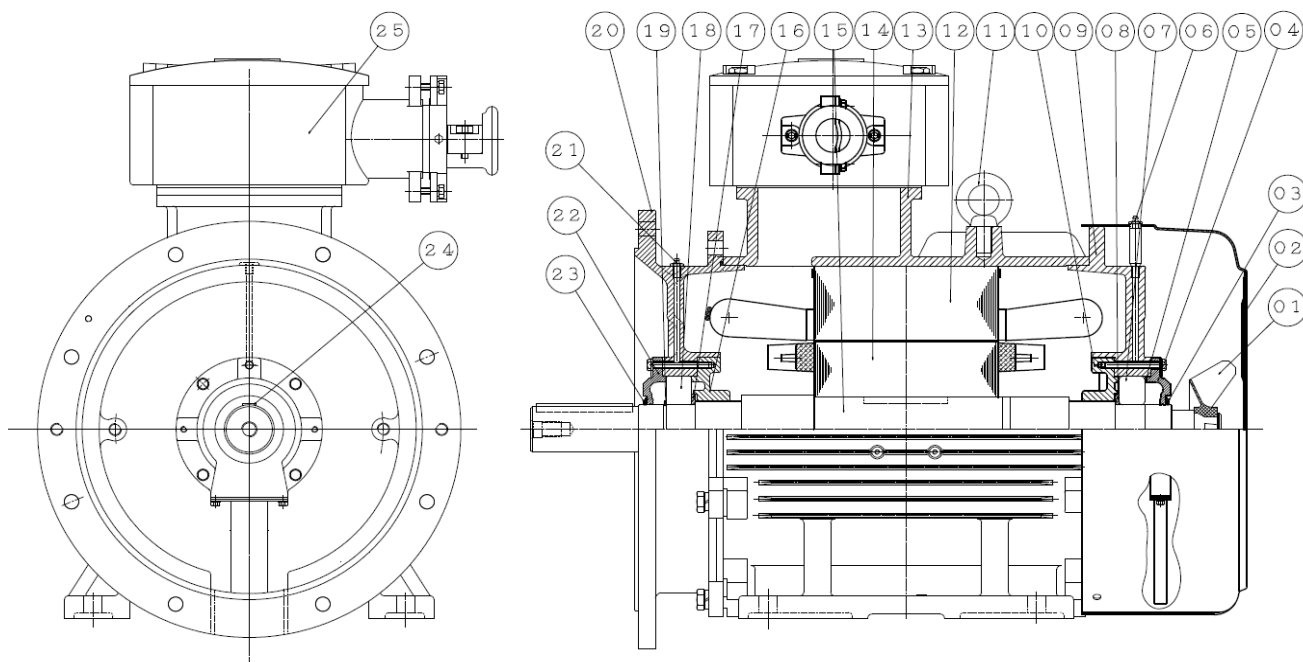

ITEM	NAME	ITEM	NAME
1	EXTERNAL FAN	15	SHAFT
2	FAN COVER	16	BEARING COVER - INNER
3	GAMMA SEAL	17	STOP RING-BEARING
4	BEARING COVER - OUTER	18	BEARING
5	PRE - LOAD SPRING	19	OUTSIDE RETAINING RING
6	GREASE NIPPLE	20	FLANGE
7	BEARING	21	GREASE NIPPLE
8	STOP RING-BEARING	22	BEARING COVER - OUTER
9	END BRACKET	23	GAMMA SEAL
10	BEARING COVER - INNER	24	KEY
11	EYE BOLT	25	TERMINAL BOX ASSY
12	STATOR		
13	FRAME		
14	ROTOR		

APPD.	Sean	30-Jun-23	TECO Electric & Machinery Co., Ltd. Wuxi, China	DWG NO.
CHKD.	JOB	30-Jun-23		32057R9928
DWN.	GGL	30-Jun-23		REV. 01
				5/8

ISSUED 30-Jun-23	SCHEMATIC DRAWING FLAMEPROOF MOTORS Ex db B35 (IM 2001) FRAME NOS.280S~280M	MODEL TEB5
REVISED 26-Dec-23		PAGE 43 of 52

Totally Enclosed Fan - Cooled Type, Squirrel - Cage Rotor.

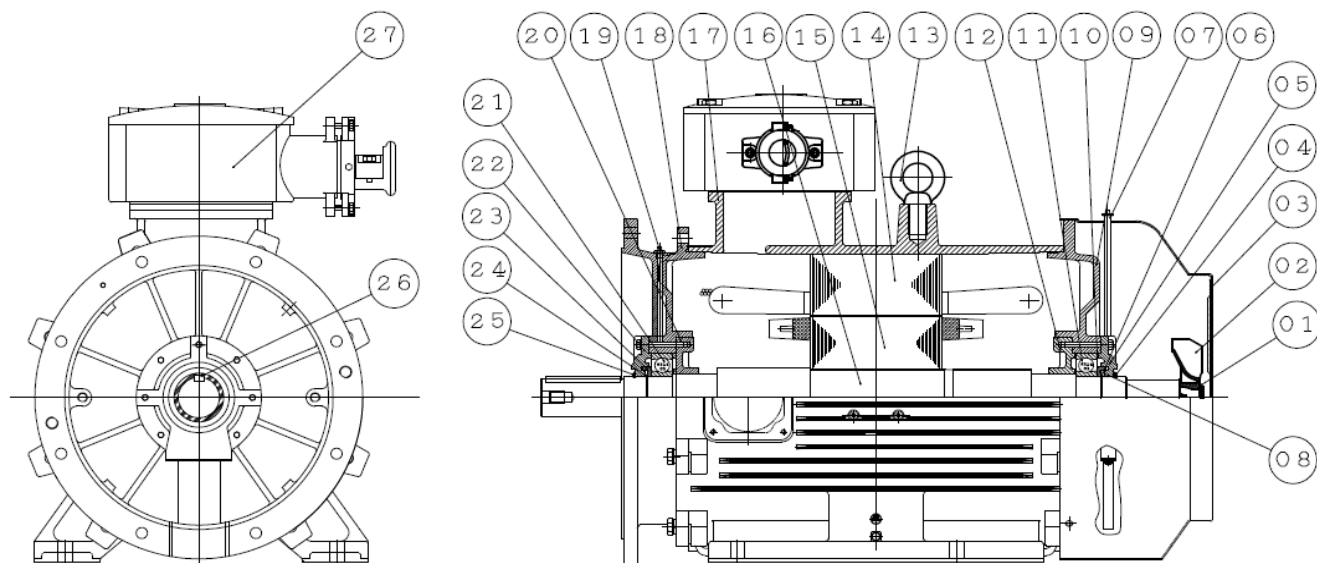

ITEM	NAME	ITEM	NAME
1	OUTSIDE RETAINING RING	16	SHAFT
2	EXTERNAL FAN	17	FRAME
3	FAN COVER	18	FLANGE
4	GAMMA SEAL	19	GREASE NIPPLE
5	BEARING COVER - OUTER	20	BEARING COVER - INNER
6	OUTSIDE RETAINING RING	21	BEARING
7	GREASE NIPPLE	22	BEARING COVER - OUTER
8	GREASE FLINGER	23	GREASE FLINGER
9	END BRACKET	24	OUTSIDE RETAINING RING
10	PRE - LOAD SPRING	25	GAMMA SEAL
11	BEARING	26	KEY
12	BEARING COVER - INNER	27	TERMINAL BOX ASSY
13	EYE BOLT		
14	STATOR		
15	ROTOR		

APPD.	Sean	30-Jun-23	TECO Electric & Machinery Co., Ltd. Wuxi, China	DWG NO.	32057R9928 REV. 01	6/8
CHKD.	JOB	30-Jun-23				
DWN.	GGL	30-Jun-23				

ISSUED 30-Jun-23	SCHEMATIC DRAWING FLAMEPROOF MOTORS Ex db B35 (IM 2001) FRAME NOS. 315	MODEL TEB5
REVISED 26-Dec-23		PAGE 44 of 52

Totally Enclosed Fan - Cooled Type, Squirrel - Cage Rotor.

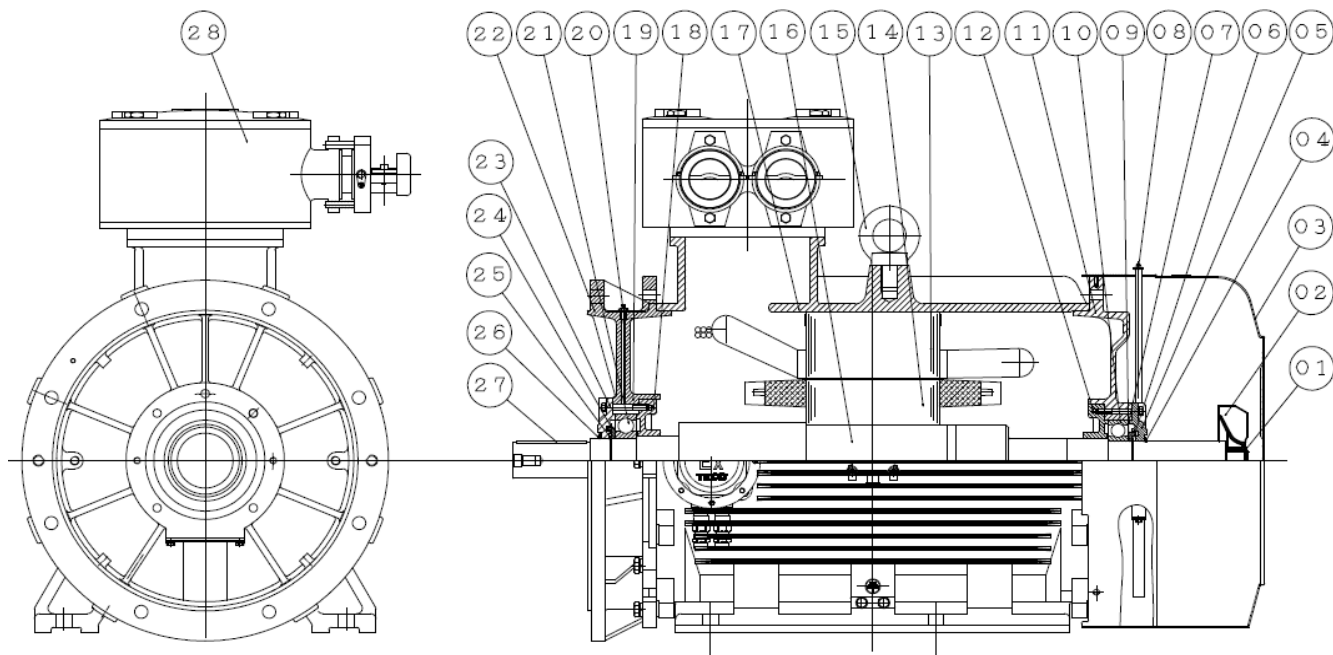

ITEM	NAME	ITEM	NAME
1	OUTSIDE RETAINING RING	16	SHAFT
2	EXTERNAL FAN	17	FRAME
3	FAN COVER	18	BEARING COVER - INNER
4	GAMMA SEAL	19	FLANGE
5	BEARING COVER - OUTER	20	GREASE NIPPLE
6	OUTSIDE RETAINING RING	21	BEARING
7	PRE - LOAD SPRING	22	BEARING COVER - OUTER
8	GREASE NIPPLE	23	GREASE FLINGER
9	GREASE FLINGER	24	OUTSIDE RETAINING RING
10	BEARING	25	GAMMA SEAL
11	END BRACKET	26	KEY
12	BEARING COVER - INNER	27	TERMINAL BOX ASSY
13	STATOR		
14	ROTOR		
15	EYE BOLT		

APPD.	Sean	30-Jun-23	TECO Electric & Machinery Co., Ltd. Wuxi, China	DWG NO.
CHKD.	JOB	30-Jun-23		32057R9928
DWN.	GGL	30-Jun-23		REV. 01

ISSUED 30-Jun-23	SCHEMATIC DRAWING FLAMEPROOF MOTORS Ex db B35 (IM 2001) FRAME NOS. 355	MODEL TEB5
REVISED 26-Dec-23		PAGE 45 of 52

Totally Enclosed Fan - Cooled Type, Squirrel - Cage Rotor.

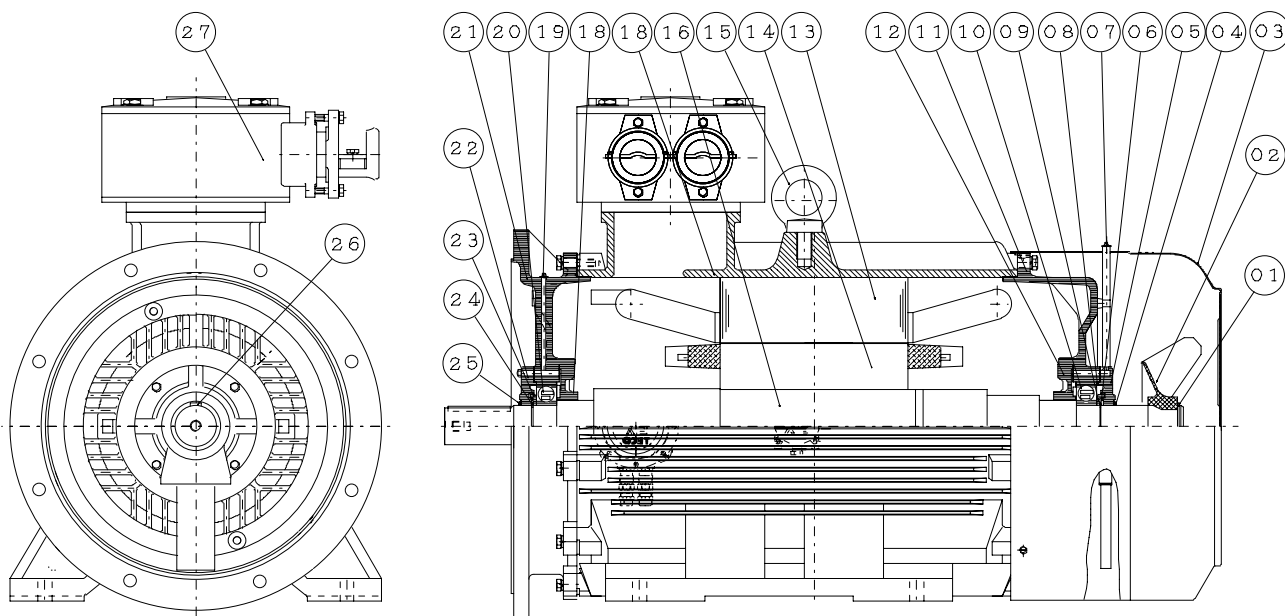

ITEM	NAME	ITEM	NAME
1	OUTSIDE RETAINING RING	16	SHAFT
2	EXTERNAL FAN	17	FRAME
3	FAN COVER	18	BEARING COVER - INNER
4	GAMMA SEAL	19	GREASE NIPPLE
5	BEARING COVER - OUTER	20	BEARING
6	OUTSIDE RETAINING RING	21	FLANGE
7	GREASE NIPPLE	22	BEARING COVER - OUTER
8	PRE - LOAD SPRING	23	GREASE FLINGER
9	GREASE FLINGER	24	OUTSIDE RETAINING RING
10	BEARING	25	GAMMA SEAL
11	END BRACKET	26	KEY
12	BEARING COVER - INNER	27	TERMINAL BOX ASSY
13	STATOR		
14	ROTOR		
15	EYE BOLT		

APPD.	Sean	30-Jun-23	TECO Electric & Machinery Co., Ltd. Wuxi, China	DWG NO.
CHKD.	JOB	30-Jun-23		32057R9928
DWN.	GGL	30-Jun-23		REV. 01

Totally Enclosed Fan - Cooled Type, Squirrel - Cage Rotor.

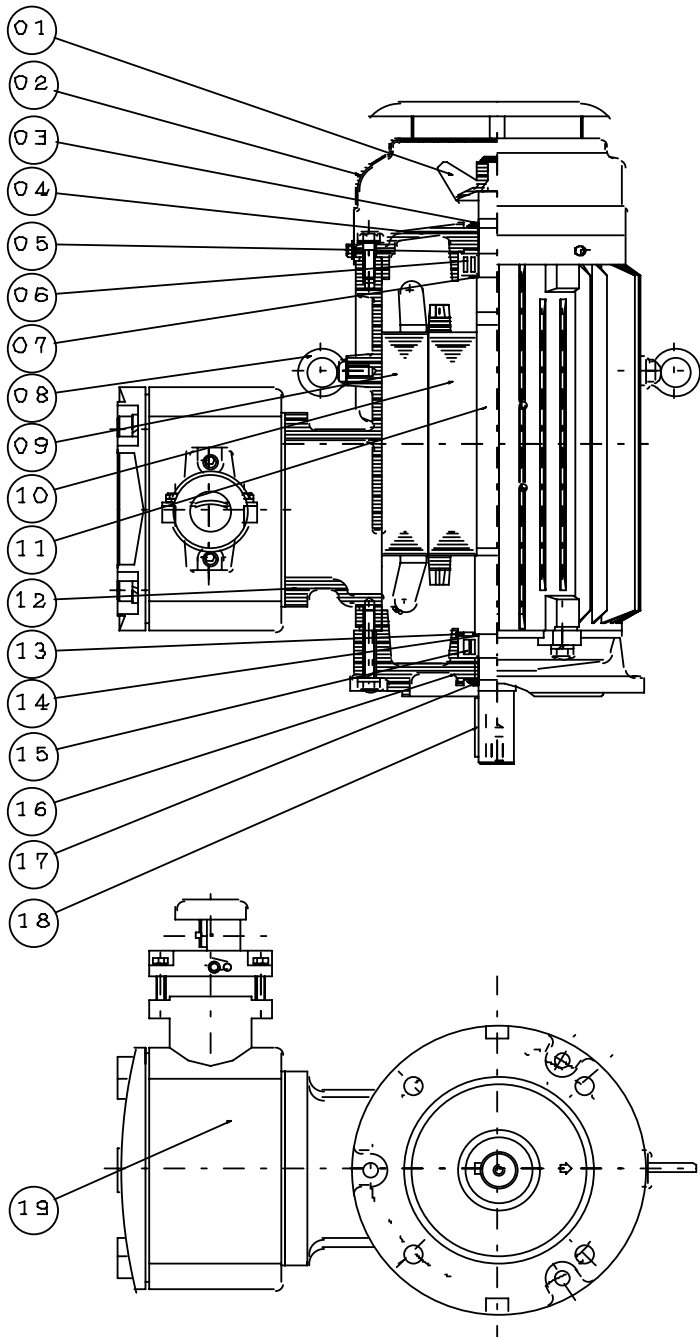

ITEM	NAME
1	EXTERNAL FAN
2	FAN COVER
3	GAMMA SEAL
4	END BRACKET
5	PRE-LOAD SPRING
6	BEARING
7	STOP RING-BEARING
8	EYE BOLT
9	STATOR
10	ROTOR
11	SHAFT
12	FRAME
13	INNER RETAINING RING
14	STOP RING-BEARING
15	BEARING
16	FLANGE
17	GAMMA SEAL
18	KEY
19	TERMINAL BOX ASSY

Totally Enclosed Fan - Cooled Type, Squirrel - Cage Rotor.

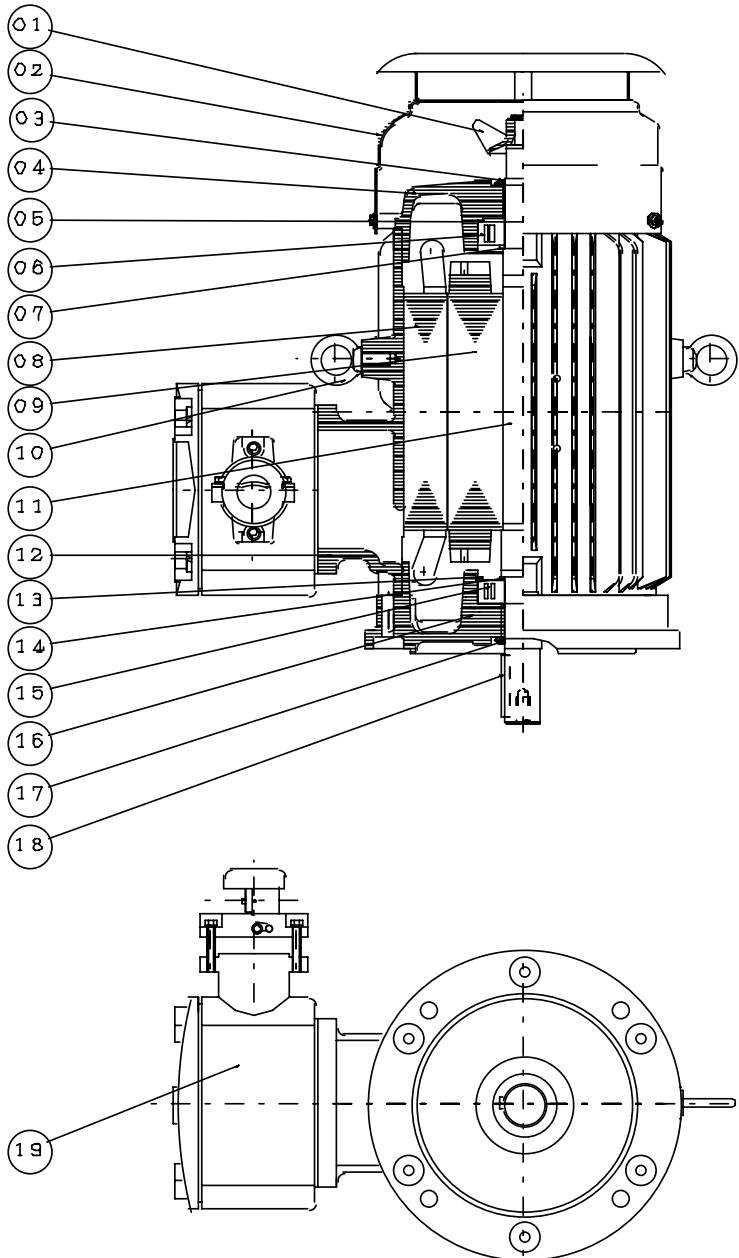

ITEM	NAME
1	EXTERNAL FAN
2	FAN COVER
3	GAMMA SEAL
4	END BRACKET
5	PRE-LOAD SPRING
6	BEARING
7	STOP RING-BEARING
8	STATOR
9	ROTOR
10	EYE BOLT
11	SHAFT
12	FRAME
13	INNER RETAINING RING
14	STOP RING-BEARING
15	BEARING
16	FLANGE
17	GAMMA SEAL
18	KEY
19	TERMINAL BOX ASSY

Totally Enclosed Fan - Cooled Type, Squirrel - Cage Rotor.

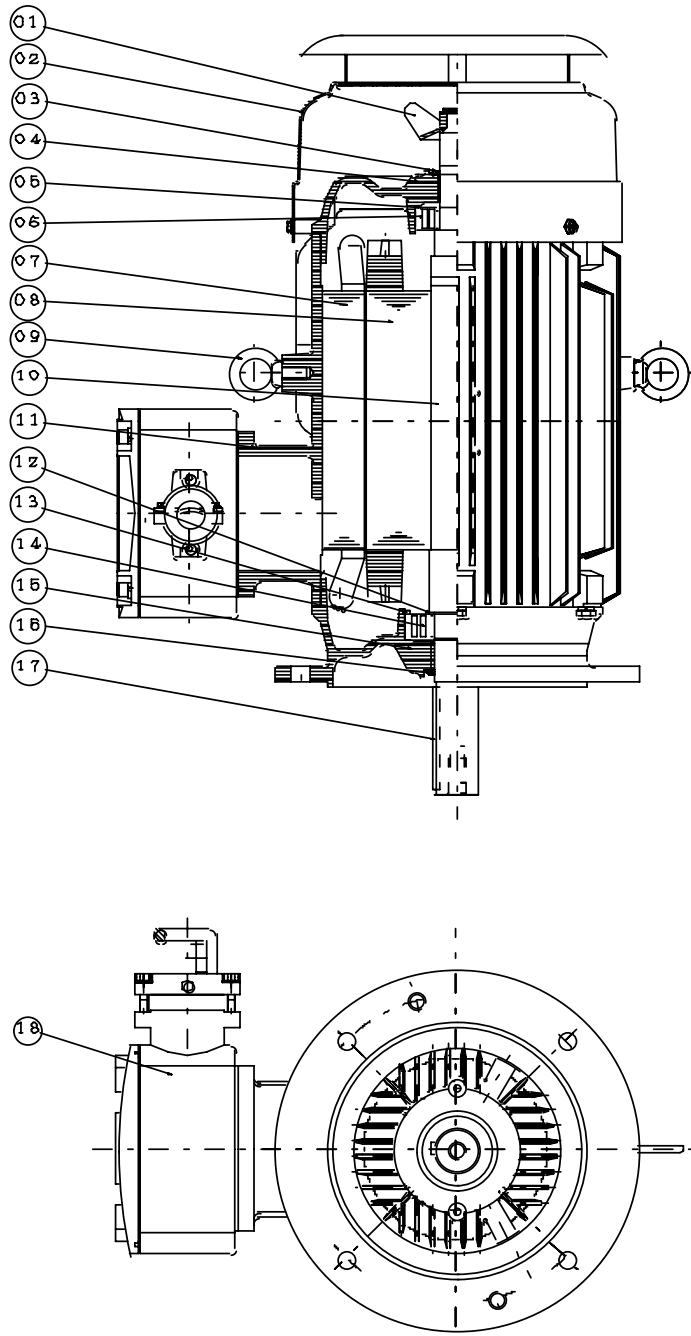

ITEM	NAME
1	EXTERNAL FAN
2	FAN COVER
3	GAMMA SEAL
4	END BRACKET
5	PRE-LOAD SPRING
6	BEARING
7	STATOR
8	ROTOR
9	EYE BOLT
10	SHAFT
11	FRAME
12	STOP RING-BEARING
13	INNER RETAINING RING
14	BEARING
15	FLANGE
16	GAMMA SEAL
17	KEY
18	TERMINAL BOX ASSY

Totally Enclosed Fan - Cooled Type, Squirrel - Cage Rotor.

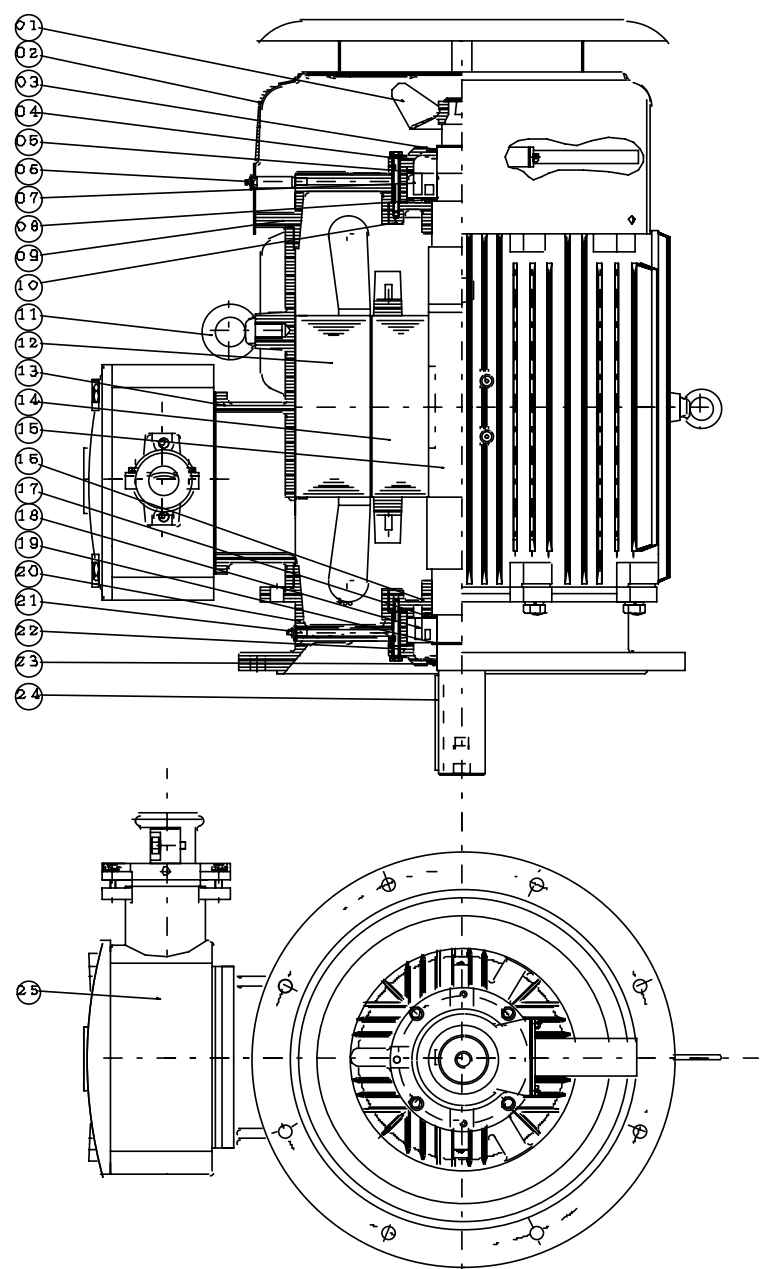

ITEM	NAME
1	EXTERNAL FAN
2	FAN COVER
3	GAMMA SEAL
4	BEARING COVER-OUTER
5	PRE-LOAD SPRING
6	GREASE NIPPLE
7	BEARING
8	STOP RING-BEARING
9	END BRACKET
10	BEARING COVER-INNER
11	EYE BOLT
12	STATOR
13	FRAME
14	ROTOR
15	SHAFT
16	BEARING COVER-INNER
17	STOP RING-BEARING
18	BEARING
19	OUTSIDE RETAINING RING
20	FLANGE
21	GREASE NIPPLE
22	BEARING COVER-OUTER
23	GAMMA SEAL
24	KEY
25	TERMINAL BOX ASSY

ISSUED	SCHEMATIC DRAWING	MODEL
30-Jun-23		TEB5
REVISED	FLAMEPROOF MOTORS Ex db	PAGE
26-Dec-23	V1 (IM 3011) FRAME NOS. 280S ~ 280M	50 of 52

Totally Enclosed Fan - Cooled Type, Squirrel - Cage Rotor.

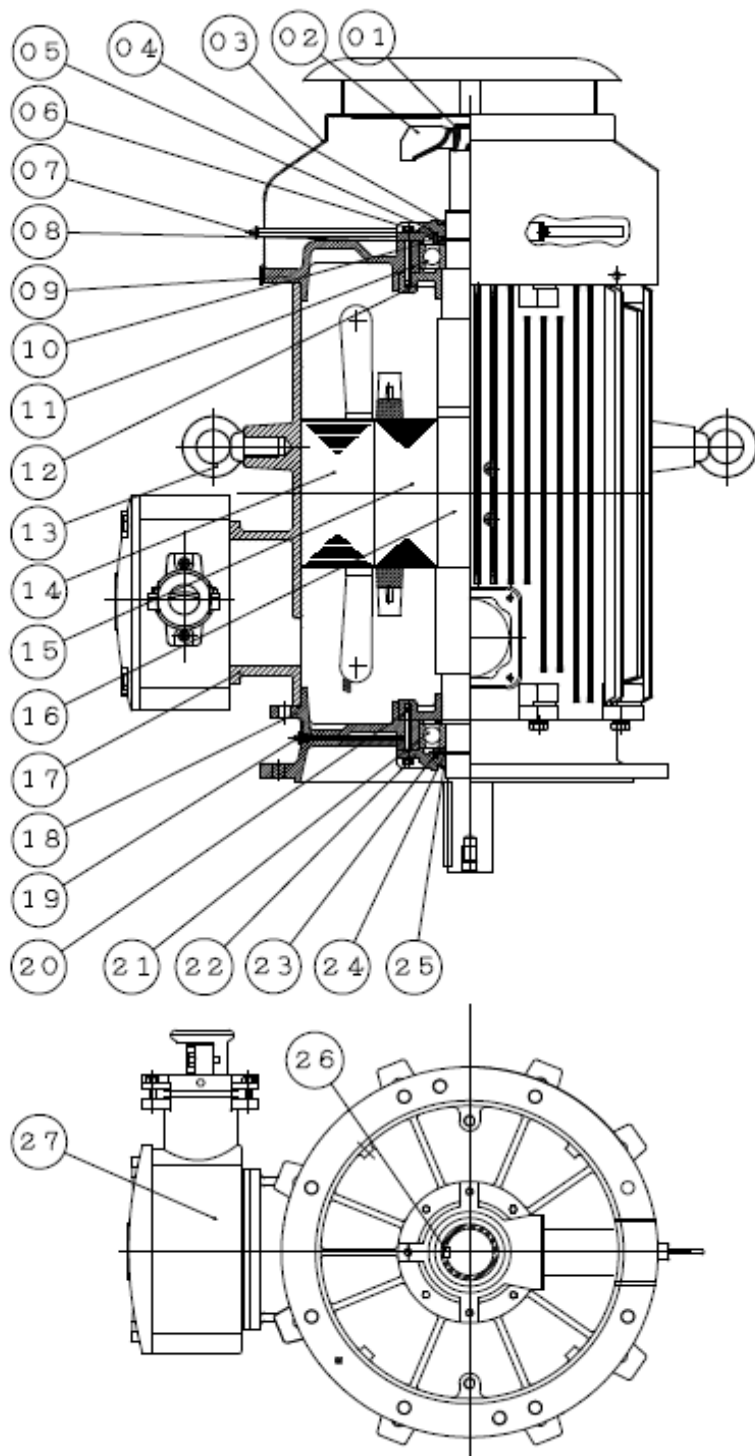

ITEM	NAME
1	OUTSIDE RETAINING RING
2	EXTERNAL FAN
3	FAN COVER
4	GAMMA SEAL
5	BEARING COVER - OUTER
6	OUTSIDE RETAINING RING
7	GREASE NIPPLE
8	GREASE FLINGER
9	END BRACKET
10	PRE - LOAD SPRING
11	BEARING
12	BEARING COVER - INNER
13	EYE BOLT
14	STATOR
15	ROTOR
16	SHAFT
17	FRAME
18	FLANGE
19	GREASE NIPPLE
20	BEARING COVER - INNER
21	BEARING
22	BEARING COVER - OUTER
23	GREASE FLINGER
24	OUTSIDE RETAINING RING
25	GAMMA SEAL
26	KEY
27	TERMINAL BOX ASSY

APPD.	Sean	30-Jun-23	TECO Electric & Machinery Co., Ltd.	DWG NO.
CHKD.	JOB	30-Jun-23		32057R9929
DWN.	GGL	30-Jun-23		REV. 01
			Wuxi, China	5/7

ISSUED 30-Jun-23	SCHEMATIC DRAWING FLAMEPROOF MOTORS Ex db V1 (IM 3011) FRAME NOS. 315	MODEL TEB5
REVISED 26-Dec-23		PAGE 51 of 52

Totally Enclosed Fan - Cooled Type, Squirrel - Cage Rotor.

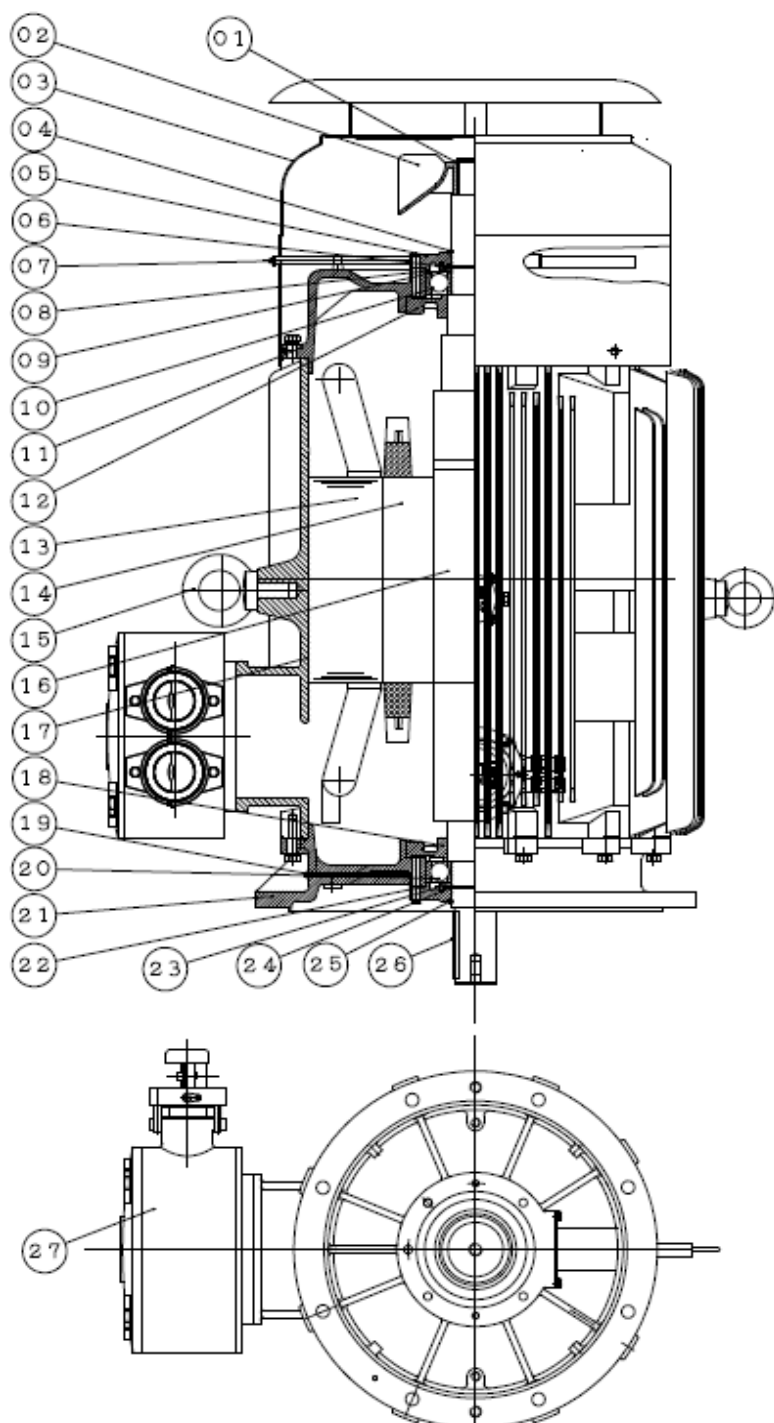

ITEM	NAME
1	OUTSIDE RETAINING RING
2	EXTERNAL FAN
3	FAN COVER
4	GAMMA SEAL
5	BEARING COVER - OUTER
6	OUTSIDE RETAINING RING
7	GREASE NIPPLE
8	PRE - LOAD SPRING
9	GREASE FLINGER
10	BEARING
11	END BRACKET
12	BEARING COVER - INNER
13	STATOR
14	ROTOR
15	EYE BOLT
16	SHAFT
17	FRAME
18	BEARING COVER - INNER
19	GREASE NIPPLE
20	BEARING
21	FLANGE
22	BEARING COVER - OUTER
23	GREASE FLINGER
24	OUTSIDE RETAINING RING
25	GAMMA SEAL
26	KEY
27	TERMINAL BOX ASSY

APPD.	Sean	30-Jun-23	TECO Electric & Machinery Co., Ltd. Wuxi, China	DWG NO.	32057R9929 REV. 01	6/7
CHKD.	JOB	30-Jun-23				
DWN.	GGL	30-Jun-23				

ISSUED	SCHEMATIC DRAWING	MODEL
30-Jun-23		TEB5
REVISED	FLAMEPROOF MOTORS Ex db	PAGE
26-Dec-23	V1 (IM 3011) FRAME NOS. 355	52 of 52

Totally Enclosed Fan - Cooled Type, Squirrel - Cage Rotor.

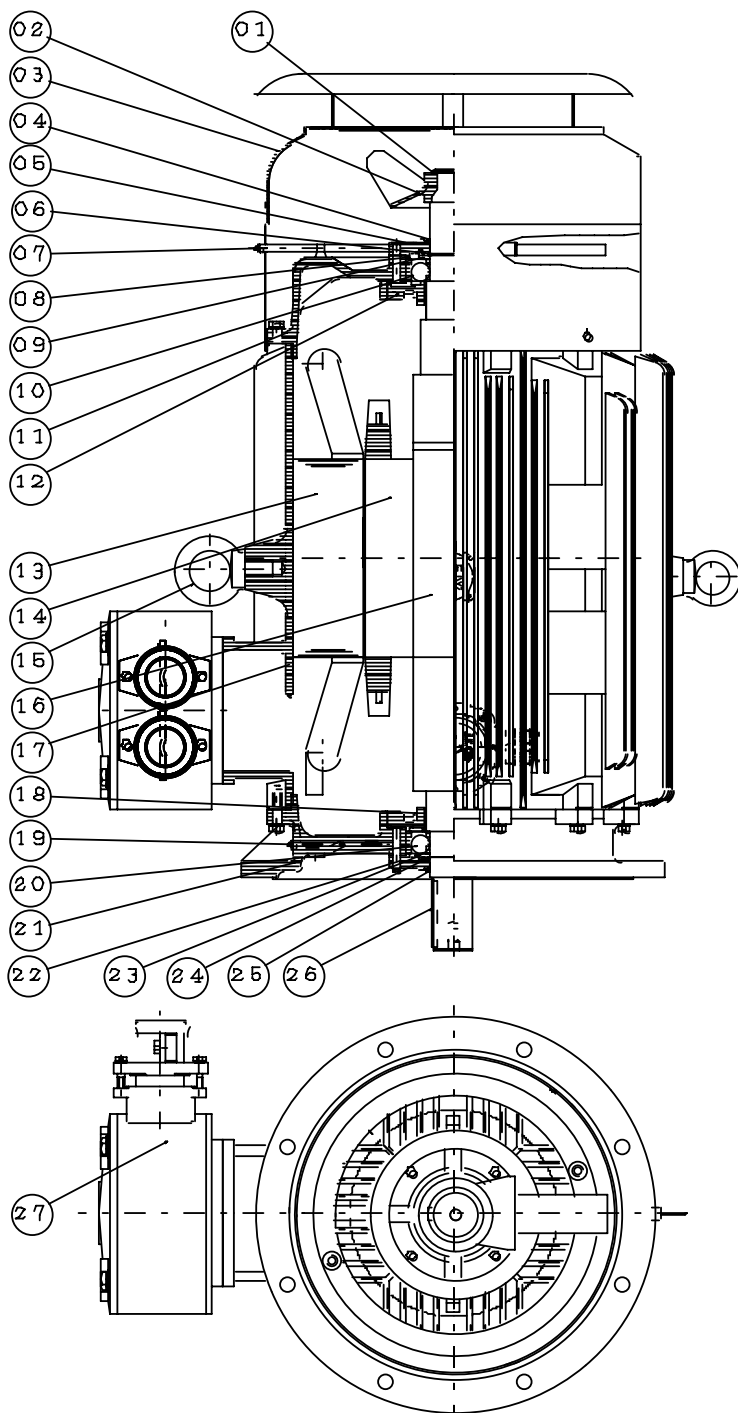

ITEM	NAME
1	OUTSIDE RETAINING RING
2	EXTERNAL FAN
3	FAN COVER
4	GAMMA SEAL
5	BEARING COVER - OUTER
6	OUTSIDE RETAINING RING
7	GREASE NIPPLE
8	PRE - LOAD SPRING
9	GREASE FLINGER
10	BEARING
11	END BRACKET
12	BEARING COVER - INNER
13	STATOR
14	ROTOR
15	EYE BOLT
16	SHAFT
17	FRAME
18	BEARING COVER - INNER
19	GREASE NIPPLE
20	BEARING
21	FLANGE
22	BEARING COVER - OUTER
23	GREASE FLINGER
24	OUTSIDE RETAINING RING
25	GAMMA SEAL
26	KEY
27	TERMINAL BOX ASSY

APPD.	Sean	30-Jun-23	TECO Electric & Machinery Co., Ltd. Wuxi, China	DWG NO.
CHKD.	JOB	30-Jun-23		32057R9929
DWN.	GGL	30-Jun-23		REV. 01
				7/7